



BG-N14

BATTERY GRIP

Designed for the Nikon Df
DSLR Camera



Introduction

Thank you for choosing the Vello BG-N14 battery grip. This camera accessory offers users the ability to extend shooting time by housing an additional battery for your device. The grip's ergonomic design enhances the comfort of vertical (portrait) shooting with the vertical-shooting shutter release button, which triggers your camera via the included shutter-release cable. Compatible with the Nikon Df DSLR camera, the Vello BG-N14 accepts up to two Nikon EN-EL14 or EN-EL14A rechargeable batteries.

Please read through this entire manual before using the BG-N14 battery grip.



Precautions

- 1.** The BG-N14 should only be used with compatible devices specified in this manual.
- 2.** Only use with batteries recommended in this manual.
- 3.** Cover the power terminals with the contact cap when the BG-N14 is not in use. This prevents electrical shorts caused by metal objects touching the power terminals.
- 4.** If you notice smoke, an unusual smell or noise from the battery pack, discontinue use immediately. Remove the batteries and take the device to a Vello authorized reseller.
- 5.** The BG-N14 does not have a power switch. Instead, use the camera's power switch to turn the power on or off.
- 6.** The battery level may not display properly if batteries are inserted before mounting the grip.
- 7.** Remove batteries from the grip when not in use.
- 8.** Do not attempt to disassemble.
- 9.** Avoid water or extreme humidity and keep in a dry and cool place.
- 10.** Keep out of reach of children.

Overview

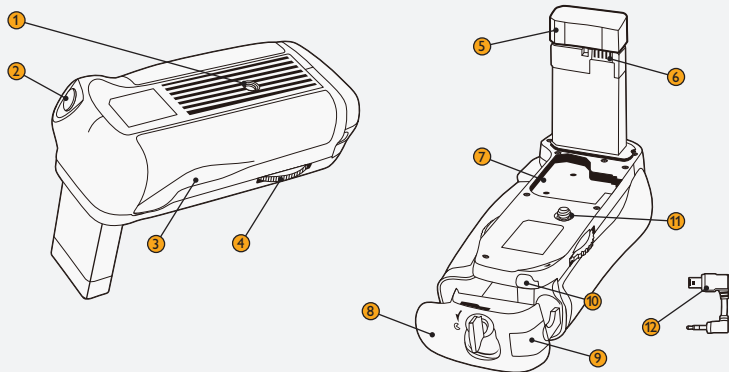

① Tripod Socket

Allows the camera to be mounted to a tripod when the grip is mounted.

② Shutter Release Button

Use as an alternate shutter release button for shooting in vertical (portrait) mode.

③ Anti-Slip Rubber Grip

Provides secure and comfortable grip when shooting vertically.

④ Attachment Wheel

Secures the grip to the camera's tripod socket.

⑤ Contact Cap

Protects metal power contacts. (Keep this cap on when the grip is not connected to the camera.)

⑥ Power Contacts

Slides into the camera's battery chamber and transmits power.

⑦ Camera Battery Door Holder

Stores the camera's battery chamber door when the grip is mounted.

⑧ Battery Tray

Secures up to two Nikon EN-EL14 or EN-EL14A batteries.

⑨ AC Power Supply Socket

Nikon EP-5A Power Supply Connector port (connector not included).

⑩ Cable Connecting Socket

Accepts sub mini connector of the shutter release cable.

⑪ Mounting Screw

Connects to the camera's tripod socket.

⑫ Shutter Release Cable

Transmits shutter release signal from battery grip to the camera.

Power Source	Two Nikon EN-EL14 or EN-EL14A Rechargeable Batteries
Operating Temperature	32°F–104°F (0°C–40°C)
Dimensions	3.9" × 2.9" × 5.7" (10.1 × 7.4 × 14.6 cm)
Weight (without batteries)	6.6 oz. (187 g)

Specifications and design are subject to change without notice.

Attaching The Grip



1. Ensure that the power is turned off on the camera.

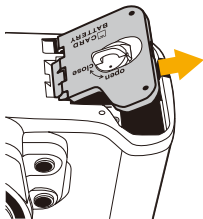

2. Turn the camera upside down and open the camera battery chamber. Pull gently at a 35° angle until the chamber door comes loose. Remove the battery from the chamber before proceeding.

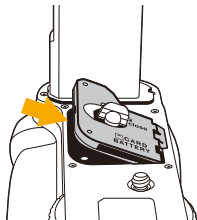

3. Insert the battery chamber door into the door receptacle on the top surface of the grip. Place the door in the receptacle at an angle as shown. Turn the locking ring clockwise to secure.

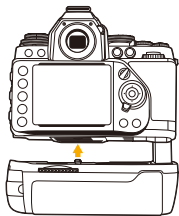

4. Insert the BG-N14 grip power contacts into the camera's battery chamber as shown. Make sure to align the camera's tripod socket with the BG-N14 mounting screw.



5. Rotate the attachment wheel in the direction shown by the arrow until it is firmly tightened.

When removing the grip, turn the camera power off, remove batteries, and replace protective contact cap.

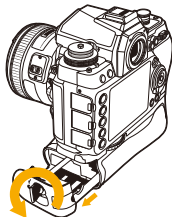

6. To insert your batteries into the camera grip, remove the battery tray from the grip by turning the battery tray latch counterclockwise and remove it from the unit.

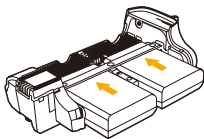

- 7.** Insert your batteries into the battery tray as shown. Once installed, reinstall the tray into the grip. Turn the battery tray latch clockwise to secure.

Note: The camera can operate with just one battery in the grip.

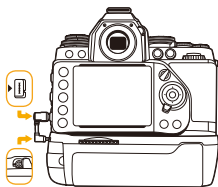

- 8.** Connect the shutter release cable from the socket on the end of the battery grip to the remote release/GPS port on the Df body.

Note: You must remove the battery grip to insert or swap out your camera's memory card.

FCC Compliance

This device complies with Part 15 of the FCC Rules. Operation is subject to the following two conditions:

1. This device may not cause harmful interference, and
2. This device must accept any interference received, including interference that may cause undesired operation.

One-Year Limited Warranty

This VELLO product is warranted to the original purchaser to be free from defects in materials and workmanship under normal consumer use for a period of one (1) year from the original purchase date or thirty (30) days after replacement, whichever occurs later. The warranty provider's responsibility with respect to this limited warranty shall be limited solely to repair or replacement, at the provider's discretion, of any product that fails during normal use of this product in its intended manner and in its intended environment. Inoperability of the product or part(s) shall be determined by the warranty provider. If the product has been discontinued, the warranty provider reserves the right to replace it with a model of equivalent quality and function.

This warranty does not cover damage or defect caused by misuse, neglect, accident, alteration, abuse, improper installation or maintenance. EXCEPT AS PROVIDED HEREIN, THE WARRANTY PROVIDER MAKES NEITHER ANY EXPRESS WARRANTIES NOR ANY IMPLIED WARRANTIES, INCLUDING BUT NOT LIMITED TO ANY IMPLIED WARRANTY OF MERCHANTABILITY OR FITNESS FOR A PARTICULAR PURPOSE. This warranty provides you with specific legal rights, and you may also have additional rights that vary from state to state.

To obtain warranty coverage, contact the Vello Customer Service Department to obtain a return merchandise authorization ("RMA") number, and return the defective product to Vello along with the RMA number and proof of purchase. Shipment of the defective product is at the purchaser's own risk and expense.

For more information or to arrange service, visit www.vellogear.com or call Customer Service at 212-594-2353.

Product warranty provided by the Gradus Group.

www.gradusgroup.com

VELLO is a registered trademark of the Gradus Group.
© 2014 Gradus Group LLC. All Rights Reserved.





© Copyright 2014 Gradus Group LLC.
All other trademarks are the property of their respective owners.

GG1