

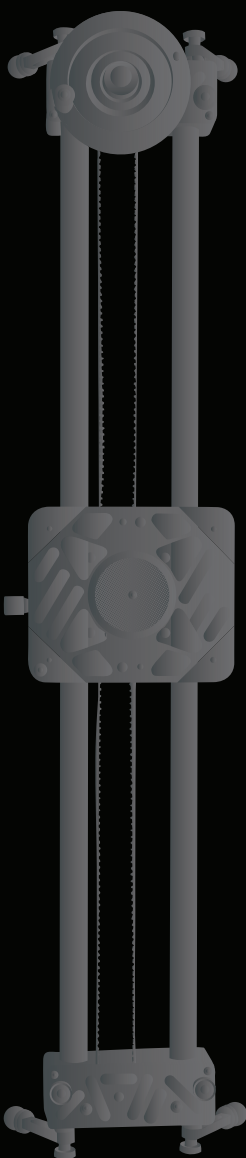

AXLER™



CS-HCS-60A

QUICK-START
GUIDE

PRECAUTIONS

- Please read and follow these instructions and keep this manual in a safe place.
- Keep this product away from children.
- Make sure everything is secure before proceeding.
- Make sure that this product is intact and that there are no missing parts.
- To avoid damage to this product, be careful not to overtighten or improperly thread any of the threaded fittings.
- Do not exceed the maximum load capacity.
- Be careful not to catch your fingers in any of the moving parts.
- All photos are for illustrative purposes only.

OVERVIEW

SLIDER:

1. Camera base
2. 1/4"-20 mount
3. Accessory mount points (1/4"-20 and 3/8"-16 sockets)
4. Bubble level
5. Brake
6. Mounting cheese plate (1/4"-20 and 3/8"-16 sockets) under camera base
7. Flywheel
8. Handle mount
9. Belt
10. Rods
11. Rod set screws
12. Adjustable feet (×4)

ALSO INCLUDED:

13. 3/8"-16 bushing (for camera mount)
14. Flywheel handle
15. Carry case
16. User manual

SPECIFICATIONS:

- Slide length:
20" (50 cm), 40" (100 cm), 60" (150 cm)
- Maximum load capacity: 50 lb. (22.7 kg)
- Mount size
 - Camera: 1/4"-20 (3/8"-16 bushing included)
 - Tripod: 1/4"-20 and 3/8"-16
- Drive type: Flywheel, belt
- Rod construction: Aluminum
- Case Dimensions (L × D × H):
27.1" × 12.9" × 5.1" × (69 × 33 × 13 cm)
- Weight: 10.5 lb. (4.8 kg)

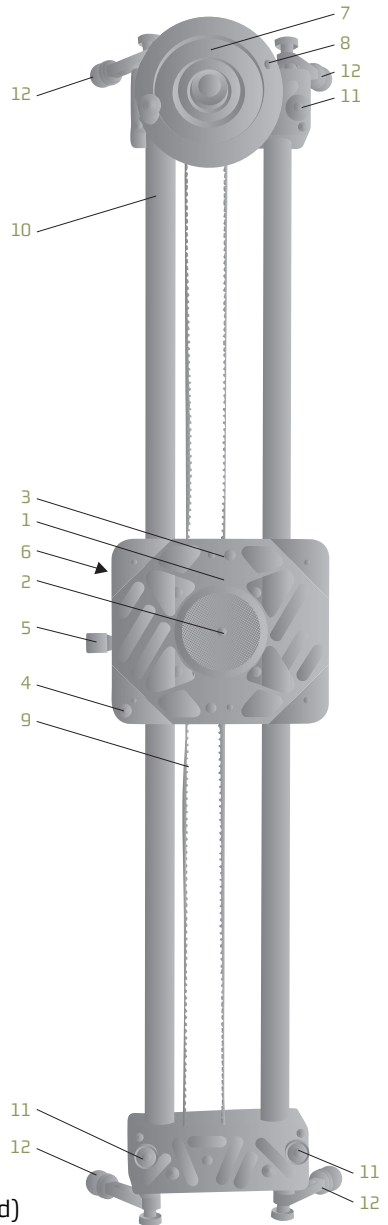

BEFORE YOU START

The Axler CS-HCS-60A Adjustable Pro Slider is a portable solution for achieving smooth, linear camera motion in your video productions. Its petite 20" (50 cm) sliding length can be doubled or even tripled with the included extension rods for up to 60" (150 cm) of belt-driven sliding at any speed. With its weighted flywheel that controls the camera movement, the slider can be operated by a single person to capture tracking shots and push-ins that will increase production value and add a cinematic quality to your films.

Four adjustable feet offer angle and height adjustment for tabletop and indoor use, and 1/4"-20 and 3/8"-16 sockets enable tripod mounting for location shooting. The camera base is equipped with a 1/4"-20 mount, and a 3/8"-16 bushing is included for compatibility with nearly any tripod head. The CS-HCS-60A disassembles for easy transportation in its compact, ultraportable carry case.

EXTENDING THE SLIDER

The CS-HCS-60A Adjustable Pro Slider comes assembled and ready to use as a 20" (50 cm) slider. Two pairs of extension 20" (50 cm) rods are included to extend the slider's length to 40" (100 cm) and 60" (150 cm).

To extend the length of the slider, follow these steps:

1. Remove the flywheel by unscrewing and removing the screw cap.
2. On the underside of the slider, loosen the belt clamps, unthread the belt, and remove it. (Fig. 1)
3. Loosen the rod set screws on both end blocks, and then remove the end blocks. (Fig. 2)
4. Attach the desired number of extension rods by screwing them onto the existing rods. Make sure to screw them on tightly. (Fig. 3)

Note: When adding both pairs of extension rods to complete the 60" (150 cm) assembly, add one pair on each end so the center mounting cheese plate is positioned halfway along the track.

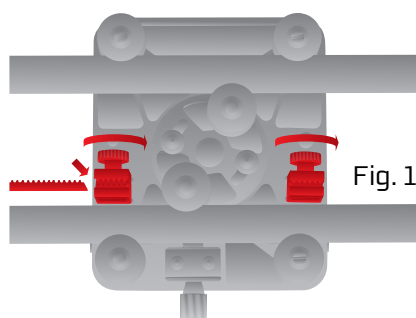

Fig. 1

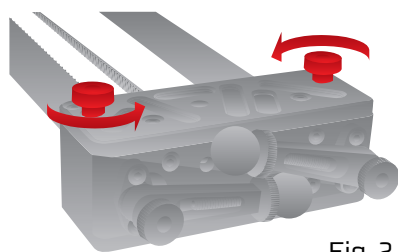

Fig. 2

Fig. 3

5. Insert the rods into their sockets in the end blocks. You may need to work the rods a bit to fit them in. (Fig. 4)
6. Make sure the rods are completely inserted into the end blocks. Lock them down by fastening the rod set screws until fully tightened.
7. On the underside of the slider, position the camera base so both belt clamps are accessible.
8. On the end blocks, rotate the feet so they point outward (see Adjusting the Feet below). This will provide easier access to the belt pulleys.
9. Select the appropriate belt for the slider's length. Fit one end of the belt into one of the belt clamps and fully tighten the belt clamp locking knob to secure the belt.
10. Thread the belt through the closest pulley and back through the slider, keeping the belt taut. Make sure the belt's teeth lock into those of the pulley, and that the belt doesn't twist. (Fig. 5)
11. Thread the belt through the other pulley and back to the other belt clamp.
12. While pulling the belt taut, fit it into the belt clamp and fully tighten the belt clamp locking knob.
13. With the slider right-side up, reattach the flywheel and attach the flywheel handle (see Attaching the Flywheel Handle).

ADJUSTING THE FEET

Place the CS-HCS-60A Pro Camera Slider on a steady surface. For enhanced artistic control over your images, you can adjust the angle and length of the feet to manipulate the orientation of the slider and achieve creative camera angles. The onboard bubble levels can be used to help achieve level shots.

ANGLE

To change the angle, loosen the thumbscrew (Fig. 6), adjust the angle (Fig. 8), and tighten the thumbscrew to lock down the new position .

LENGTH

To extend the foot, (Fig. 7) first rotate the foot to the desired length and then hold onto the rubber foot while rotating the washer in the opposite direction so it travels up the threaded post to secure the new position.

To retract the foot, first rotate the washer down the post so it sits firmly against the rubber foot, and then rotate the foot in the opposite direction so the it retracts.

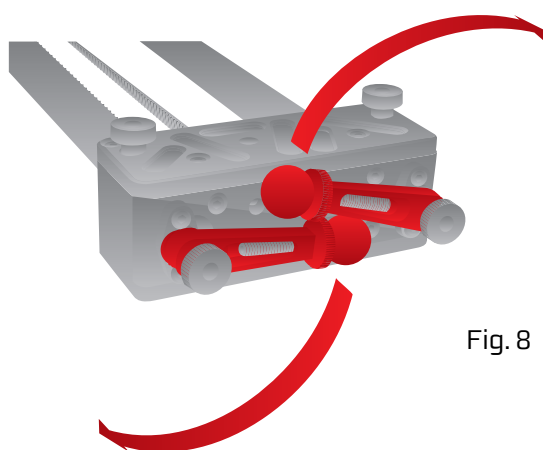
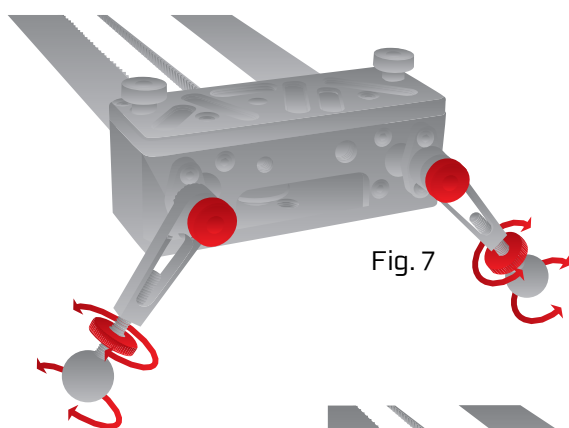
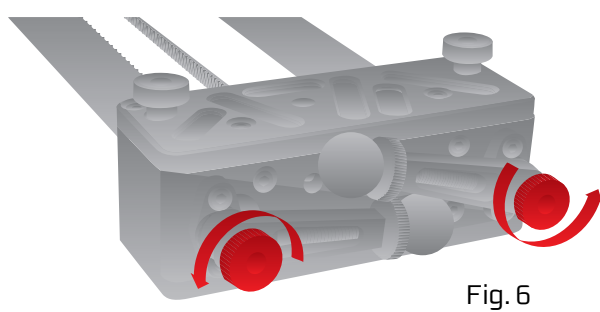
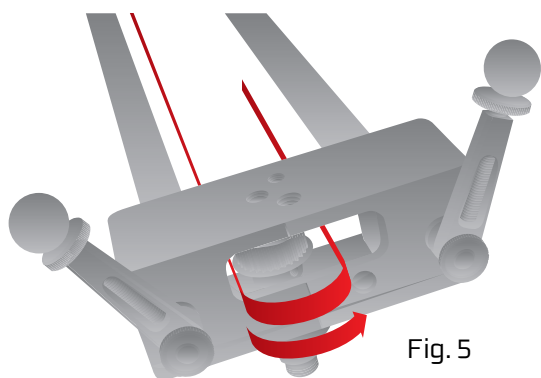

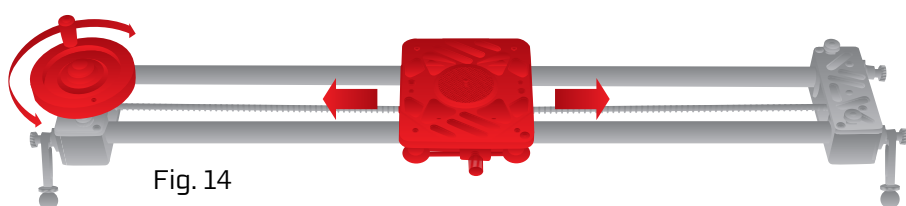
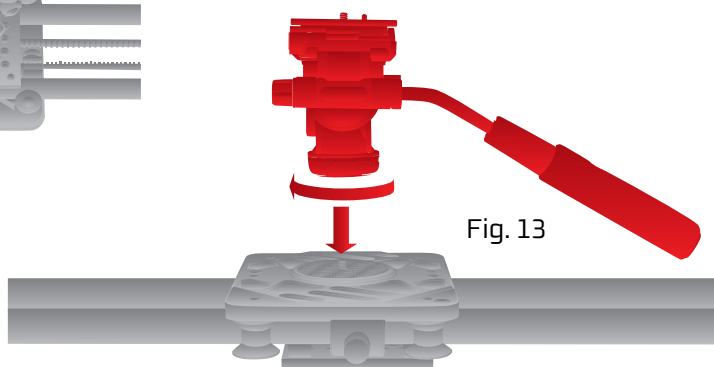
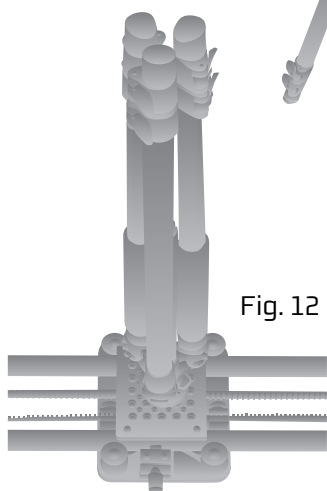
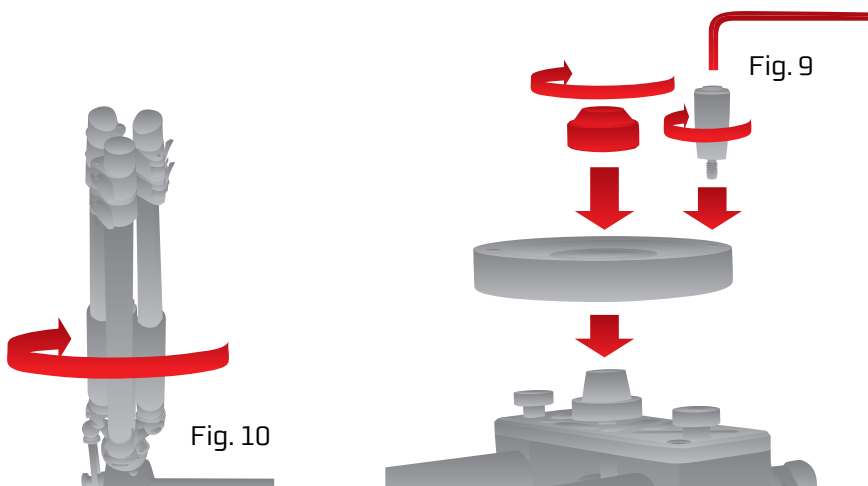

ATTACHING THE FLYWHEEL HANDLE

The flywheel handle helps you continuously rotate the flywheel to attain smooth camera motion along the slider. Use a 3/16" hex key to screw the flywheel handle into the flywheel handle mount (Fig. 9).

MOUNTING THE SLIDER

Use at least two tripods or light stands to support the slider (Fig. 11). Each end of the slider is equipped with 1/4"-20 and 3/8"-16 sockets. If your rig is heavy and requires further support, add a third tripod to the center mounting cheese plate, which is also equipped with 1/4"-20 and 3/8"-16 sockets (Fig. 12).

To mount the slider, follow these steps:

1. Center the camera base on the slider and lock it down by tightening the brake.
2. Align your tripod's threaded post with the corresponding one in the slider, and screw it in until secure. Do this for both tripods (Fig. 10).

Tip: It may be easier to turn the slider upside down to screw in your tripods.

Note: To avoid wobbling and camera shake, use sand bags or other weights to stabilize your tripods.

MOUNTING YOUR CAMERA TO THE SLIDER

Important!

Before mounting your camera, lock down the camera base by tightening the brake.

Note: If your tripod head has a 3/8"-16 socket, use the included 3/8"-16 bushing.

1. Secure the slider on stable, level ground before mounting.
2. Tighten the brake on the camera base.
3. Rotate the tripod head clockwise until it is flush with the camera platform and secure.

Important!

DO NOT MOUNT THE TRIPOD HEAD WITH THE CAMERA STILL ATTACHED! Only mount the camera once the tripod head is secure on the camera platform.

Note: If your tripod head has a 3/8"-16 socket, use the included 3/8"-16 bushing.

USING THE SLIDER

Once your camera is mounted, loosen the brake and rotate the flywheel to move your camera along the slider. If the slider is positioned at an incline, keep one hand on the camera base before loosening the brake. (Fig. 14)



ONE-YEAR LIMITED WARRANTY

This Axler product is warranted to the original purchaser to be free from defects in materials and workmanship under normal consumer use for a period of one (1) year from the original purchase date or thirty (30) days after replacement, whichever occurs later. The warranty provider's responsibility with respect to this limited warranty shall be limited solely to repair or replacement, at the provider's discretion, of any product that fails during normal use of this product in its intended manner and in its intended environment. Inoperability of the product or part(s) shall be determined by the warranty provider. If the product has been discontinued, the warranty provider reserves the right to replace it with a model of equivalent quality and function.

This warranty does not cover damage or defect caused by misuse, neglect, accident, alteration, abuse, improper installation or maintenance. EXCEPT AS PROVIDED HEREIN, THE WARRANTY PROVIDER MAKES NEITHER ANY EXPRESS WARRANTIES NOR ANY IMPLIED WARRANTIES, INCLUDING BUT NOT LIMITED TO ANY IMPLIED WARRANTY OF MERCHANTABILITY OR FITNESS FOR A PARTICULAR PURPOSE. This warranty provides you with specific legal rights, and you may also have additional rights that vary from state to state.

To obtain warranty coverage, contact the Axler Customer Service Department to obtain a return merchandise authorization ("RMA") number, and return the defective product to Axler along with the RMA number and proof of purchase. Shipment of the defective product is at the purchaser's own risk and expense.

For more information or to arrange service, visit www.axlersupports.com or call Customer Service at 212-594-2353.

Product warranty is provided by the Gradus Group.
www.gradusgroup.com

Axler is a registered trademark of the Gradus Group

© 2015 Gradus Group LLC. All Rights Reserved.



www.AxlerSupports.com