

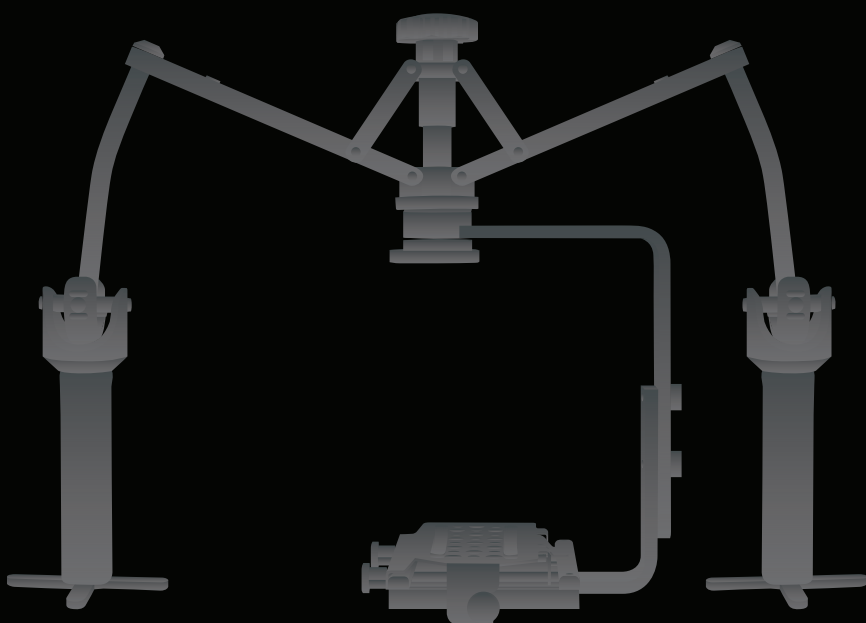

AXLER™



NBS-2X

NIMBUS  
STABILIZER

QUICK-START  
GUIDE

## PRECAUTIONS

- Please read and follow these instructions and keep this manual in a safe place.
- Keep this product away from children.
- Make sure everything is secure before proceeding.
- Make sure that this product is intact and that there are no missing parts.
- To avoid damage to this product, be careful not to overtighten or improperly thread any of the threaded fittings.
- Do not exceed the maximum load capacity.
- Be careful not to catch your fingers in any of the moving parts.
- All photos are for illustrative purposes only.

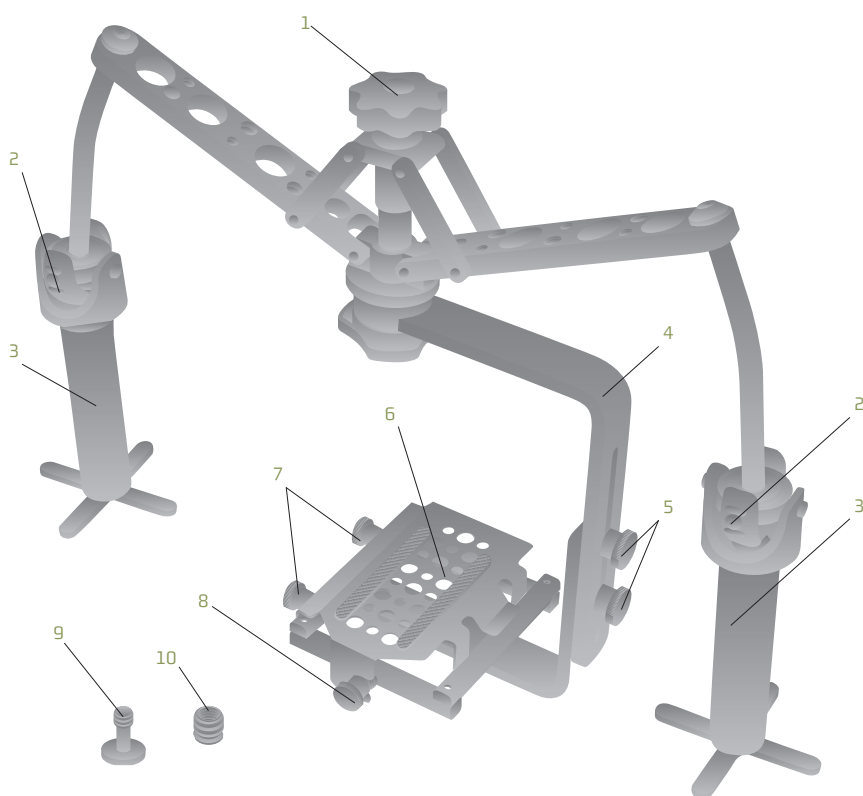

## OVERVIEW

### STABILIZER:

1. Top knob
2. Thumb grips
3. Handles
4. Bracket
5. Bracket locking knobs
6. Cheese plate
7. Cheese plate locking knobs
8. Cheese plate fore/aft adjustment knob

### ALSO INCLUDED:

9. 1/4"-20 camera screw
10. 3/8"-16 bushing
11. User manual

## BEFORE YOU START

This quick-start guide contains some basic instructions for balancing the Nimbus Dual-Axis Mechanical Stabilizer. Setting up a stabilizer like the Nimbus is not complicated, but it takes some fine-tuning. Don't feel discouraged if it takes a few tries to balance the stabilizer—a little patience goes a long way.

Before you start, set up your camera in the exact way that you are going to use it when shooting with the Nimbus Stabilizer. For example, if you are going to use your camera's LCD panel, make sure to extend the panel before mounting your camera onto the stabilizer. Similarly, make sure that any accessories are already onboard. Any change to the camera's balance will change its center of gravity, making it necessary to readjust the stabilizer.

## MOUNTING YOUR CAMERA

1. Remove the cheese plate by unscrewing the cheese plate locking knobs. (Fig. 1)
2. Position your camera on the cheese plate, with your camera's lens at the front and the cheese plate's hook at the rear, and align your camera's center of gravity on the cheese plate.
3. Use the included camera screw to attach your camera to the cheese plate. If your camera has a 3/8"-16 socket, use the included bushing.
4. Mount the cheese plate/camera assembly onto the bracket. Make sure the rear hook fits into the corresponding groove on the fore/aft adjustment knob. (Fig. 2)
5. Screw the cheese plate locking knobs into place to secure the cheese plate's position on the bracket.

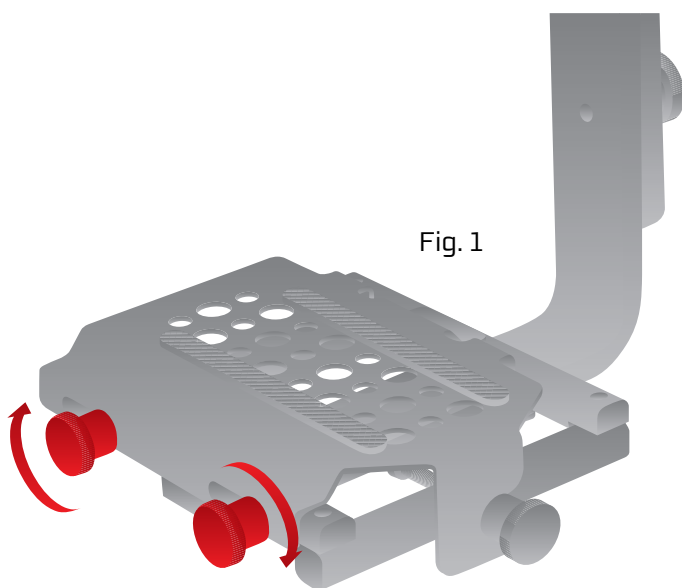

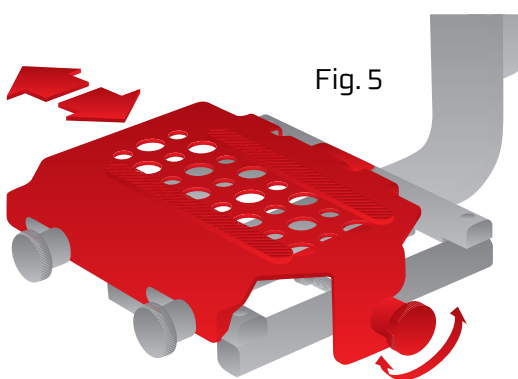
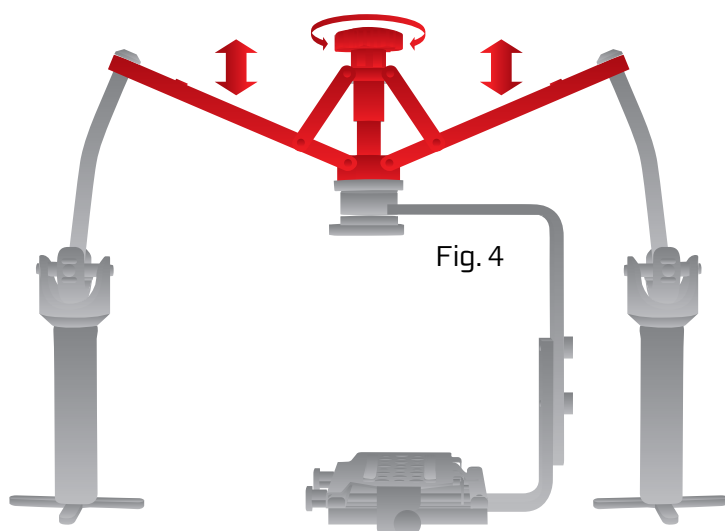
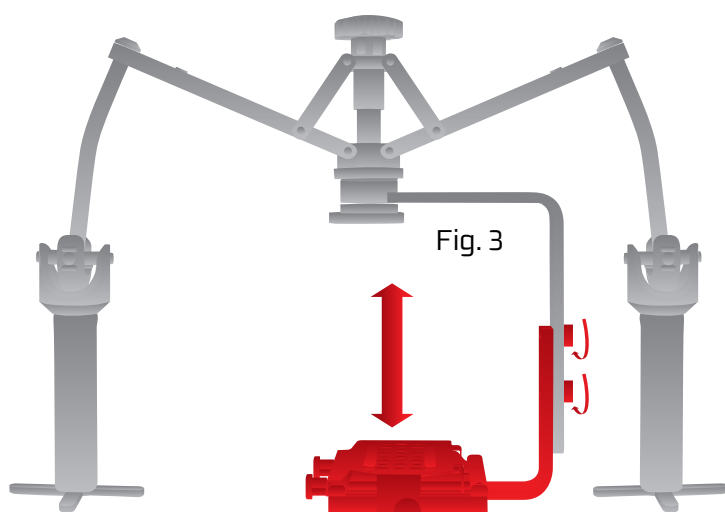
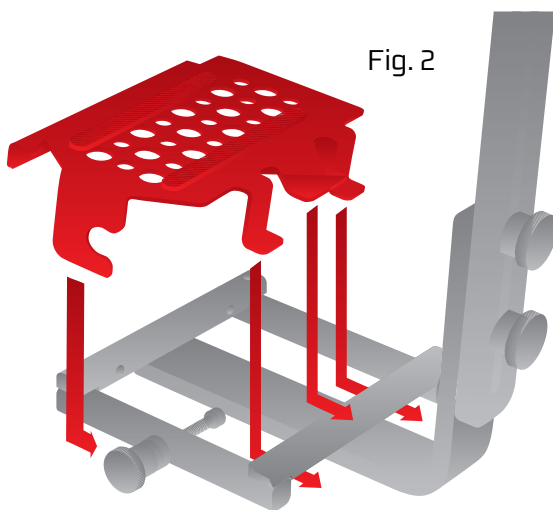

## BALANCING THE STABILIZER

*Tip: Use a three-way bubble level (not included) as a guide.*

1. Stand the stabilizer on the handles, with the cheese plate's fore/aft adjustment knob facing you.
2. Loosen the bracket locking knobs and raise the bracket as high as possible while leaving some space between the camera and the mounting knobs. Tighten the bracket locking knobs to secure the position (Fig. 3).
3. Rotate the top knob counterclockwise to lower the stabilizer's center of gravity so that it is equal with the gimbals on each side. (Fig. 4)
4. Loosen the cheese plate locking knobs and use the cheese plate's fore/aft adjustment knob to balance the stabilizer on the horizontal axis. (Fig. 5) You may have to remove the camera from the plate and reattach it through a different hole. Tighten the cheese plate locking knobs to secure the position.
5. Once the stabilizer is balanced on the horizontal axis, pull your camera back and then let go. It should drop slowly and come to rest evenly on the horizontal axis.
  - a. If the stabilizer drops too fast, lower the bracket or rotate the top knob counterclockwise to lower the center of gravity.
  - b. If the camera rests at an angle, use the cheese plate fore/aft adjustment knob to fine-tune your camera's pitch on the horizontal axis.

**Note: Make sure to tighten the cheese plate locking knobs before using the stabilizer.**

6. After balancing the stabilizer on the horizontal and vertical axes, lift the unit and repeatedly thrust it back and forth, side to side, and up and down. Your camera should remain level, no matter what direction you move it. If it swings out of alignment, return the stabilizer to the balancing platform and readjust it.

## SPECIFICATIONS:

- Maximum load capacity: 11 lb. (5 kg)
- Plate depth: 6" (15.2 cm)
- Dimensions
  - Height (maximum): 16" (40.6 cm)
  - Width (maximum): 16" (40.6 cm)
  - Depth (maximum): 6" (15.2 cm)
- Weight: 3.75 lb (1.7 kg)

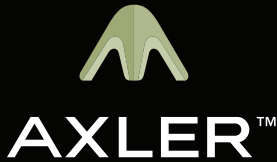

## ONE-YEAR LIMITED WARRANTY

This Axler product is warranted to the original purchaser to be free from defects in materials and workmanship under normal consumer use for a period of one (1) year from the original purchase date or thirty (30) days after replacement, whichever occurs later. The warranty provider's responsibility with respect to this limited warranty shall be limited solely to repair or replacement, at the provider's discretion, of any product that fails during normal use of this product in its intended manner and in its intended environment. Inoperability of the product or part(s) shall be determined by the warranty provider. If the product has been discontinued, the warranty provider reserves the right to replace it with a model of equivalent quality and function.

This warranty does not cover damage or defect caused by misuse, neglect, accident, alteration, abuse, improper installation or maintenance. EXCEPT AS PROVIDED HEREIN, THE WARRANTY PROVIDER MAKES NEITHER ANY EXPRESS WARRANTIES NOR ANY IMPLIED WARRANTIES, INCLUDING BUT NOT LIMITED TO ANY IMPLIED WARRANTY OF MERCHANTABILITY OR FITNESS FOR A PARTICULAR PURPOSE. This warranty provides you with specific legal rights, and you may also have additional rights that vary from state to state.

To obtain warranty coverage, contact the Axler Customer Service Department to obtain a return merchandise authorization ("RMA") number, and return the defective product to Axler along with the RMA number and proof of purchase. Shipment of the defective product is at the purchaser's own risk and expense.

For more information or to arrange service, visit [www.axlersupports.com](http://www.axlersupports.com) or call Customer Service at 212-594-2353.

Product warranty is provided by the Gradus Group.  
[www.gradusgroup.com](http://www.gradusgroup.com)

Axler is a registered trademark of the Gradus Group

© 2015 Gradus Group LLC. All Rights Reserved.



[www.AxlerSupports.com](http://www.AxlerSupports.com)