

QUICKSTART MANUAL (ENGLISH)

TABLE OF CONTENTS

1	Table of Contents
2	Warnings and Important Notes
4	Overview
6	How to switch Camera Mounts: CGO1™ to GoPro3/3+
7	How to switch Camera Mounts: GoPro3/3+® to CGO1™
9	Mounting CGO1™ on GB200™
9	Mounting GoPro® on GB200™
9	Mounting GB200™ on Blade® 350QX2
13	GB200™ LED Status
14	Spare Parts and compatible products
14	Troubleshooting Guide
16	Limited Warranty

WARNINGS AND IMPORTANT NOTES

Warning: Do not move, sway or shake the model during the initialization process. Moving, shaking or swaying the model during the initialization process may lead to initialization failure, which will require you to cycle the power off and then back on to repeat the process. Adjusting or modifying the GB200™ in anyway is not recommended. Prior to using the GB200™, read and understand the quick start guide and instruction manual completely. Always power on your transmitter first and then power on your model and gimbal.

YUNEEC™ GB200™ gimbal is optimized for both the CGO1™ and GoPro3/3+® cameras. Please mount your camera to the GB200™ without adjusting or modifying the GB200™. Do not modify or add any other component / device (such as filters, lens, plastic case, hood, etc.) to the camera. Also, it's important to make sure to use the original battery for your chosen camera, or the change in weight and center of gravity of the camera may decrease performance of GB200™ or even cause internal malfunction.

Make sure your model's autopilot system operates in the safest manner when the main power battery is connected. We strongly recommend that you remove all blades/propellers, use a suitable flight battery, and keep a safe distance from children and other people during gimbal setup. Please follow these important steps to mount and connect the GB200™ gimbal on your model, and respect the AMA's National Model Aircraft Safety Code.

YUNEEC™ has no control over the use, setup, final assembly or modification (including use of non-specified YUNEEC™ parts i.e. motors, flight controllers, motor controllers, blades/propellers, etc.) or misuse. Therefore no liability shall be assumed nor accepted for any resulting damage or injury. By the act of use, setup or assembly, the user accepts all resulting liability. YUNEEC™ assumes no liability for damage(s) or injuries incurred directly or indirectly from the use of this product.

YUNEEC™ and GB200™ are trademarks or registered trademarks of Yuneec International Co., Ltd.. This product and manual are copyrights of YUNEEC™ with all rights reserved. No part of this product or manual shall be reproduced in any form without the prior written consent or authorization from YUNEEC™. Furthermore, no other liability is assumed with respect to the use of the product or information contained herein. YUNEEC™ reserves the right to update manuals and quickstart guides any time. For warranty information, please visit www.Yuneec.com

OVERVIEW

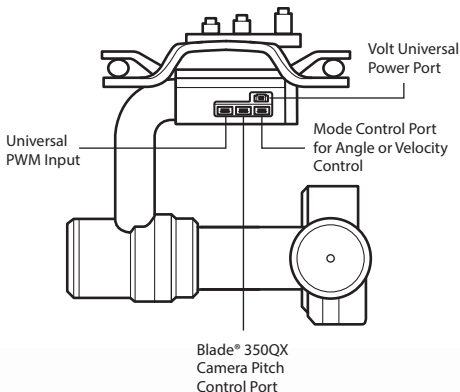

DIFFERENCE BETWEEN ANGLE OR VELOCITY MODE:

Angle Mode allows the 'pitch' angle of the camera gimbal to be changed relative to the PWM control stick/knob/slider input. Velocity Mode controls the speed/rate of the 'pitch' angle of the camera according to PWM control stick/knob/slider input. For example, the more control input, the faster the rate of change will be.

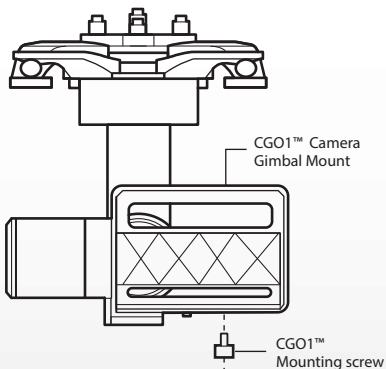
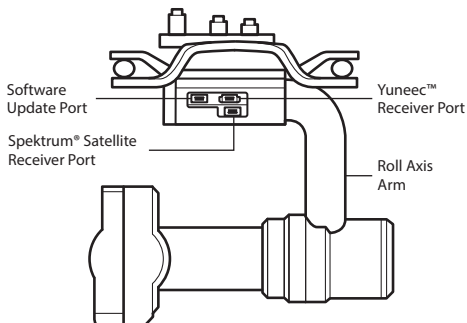

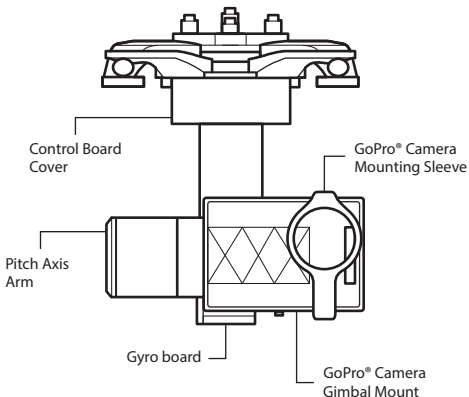

HOW TO SWITCH CAMERA MOUNTS: CGO1™ to GoPro3/3+® (A)

Step 1: Rotate the CGO1™ camera mount - as shown in illustration A - until the flat spot inside the setscrew hole is facing up, and loosen the setscrew using the allen wrench.

Step 2: Carefully remove the CGO1™ camera mount by sliding it outward away from the gimbal motor and remove the gyro board from the gyro board mount.

Step 3: Insert gyro board into the gyro board mount on the GoPro® camera mount, and wrap the gyro board wire harness clockwise one whole turn around the end of the camera mount toward the gimbal motor.

Step 4: Spin the gimbal motor shaft until the 'flat spot' is facing the setscrew hole. Insert and tighten the setscrew to secure the GoPro® mount to the GB200™.

HOW TO SWITCH CAMERA MOUNTS: GoPro3/3+® to CGO1™ (B)

Step 1: Rotate the GoPro® camera mount - as shown in illustration B - until the flat spot inside the setscrew hole is facing up, and loosen the setscrew using the hex wrench.

Step 2: Carefully remove the GoPro® camera mount by sliding it outward away from the gimbal motor and remove the gyro board from the gyro board mount.

Step 3: Insert gyro board into the gyro board mount on the CGO1™ camera mount, and wrap the gyro board wire harness clockwise one whole turn around the end of the camera mount toward the gimbal motor.

Step 4: Spin the gimbal motor shaft until the 'flat spot' is facing the setscrew hole. Insert and tighten the setscrew to secure the CGO1™ mount to the GB200™.

Illustration A:
CGO1™ mount

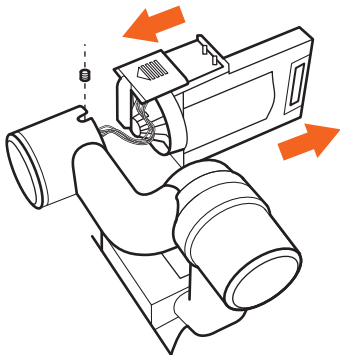
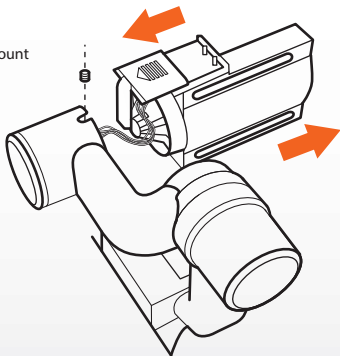

Illustration B:
GoPro3/3+® mount



MOUNTING CGO1™ ON GB200 (C)

1. Remove the 5.8GHz Wi-Fi antenna from the CGO1™.
2. Install the CGO1™ into the CGO1™ camera mount.
3. Connect the 5.8GHz Wi-Fi antenna by pressing it onto the 5.8GHz antenna socket on the CGO1™ and turn it 90° to secure the antenna to the CGO1™ and camera mount.
4. Install the 3mm mounting screw to secure the CGO1™ to the mount.

MOUNTING GOPRO® ON GB200™ (D)

1. Install GoPro3/3+® in the GoPro3/3+® mount
2. use the GoPro3/3+® mounting sleeve to secure the camera to the mount. (see illustration)

MOUNTING GB200™ ON BLADE® 350QX (E,F,G and H)

1. Install the GB200™ gimbal mounting plate on the 350QX using the (4) included screws.
2. Slide the GB200™ into place with the arm side toward the back of the model.
3. Connect the Blade® 350 QX2 control cable to the camera pitch control port on the GB200™ and the corresponding port on the Blade® 350QX V2.
4. Place the Blade® 350 QX2 on a flat and stable surface. Switch on the Blade® 350 QX2. Do not move, sway or shake the model during the automatic calibration process. After the automatic calibration is complete, your GB200™ is ready to use.

Illustration C:
Mounting CGO1™
camera

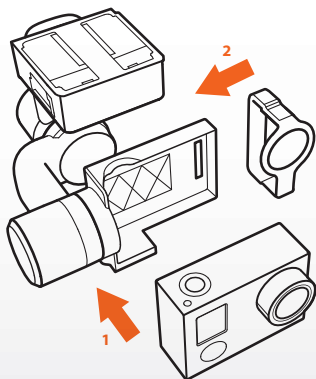
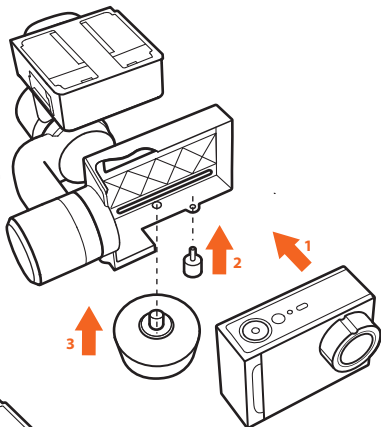

Illustration D:
Mounting GoPro®
camera

Illustration E: Installing the mounting plate to Blade® 350 QX2

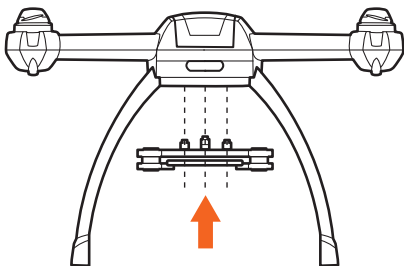
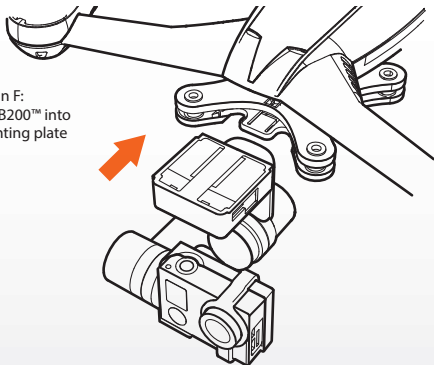

Illustration F:
Sliding GB200™ into
the mounting plate



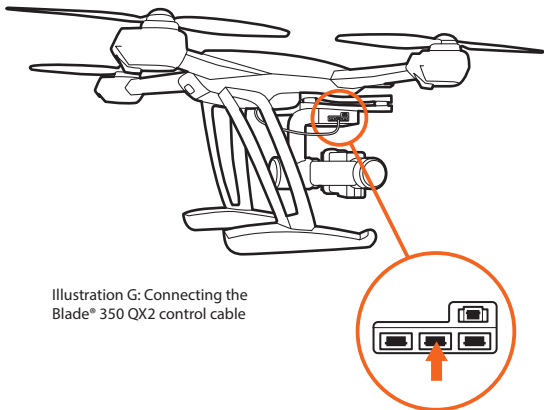
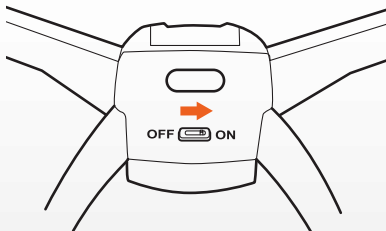
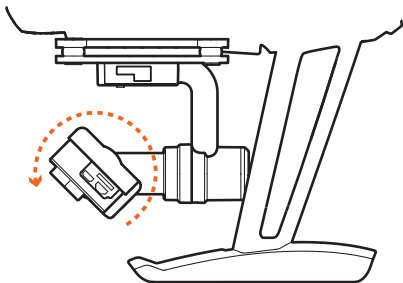

Illustration G: Connecting the Blade® 350 QX2 control cable

Illustration H: Powering on the Blade® 350 QX2





TIP: The pitch axis neutral position can be changed by holding your desired pitch axis position within 5 seconds after the gimbal initializes.

GB200™ LED STATUS

ANGLE CONTROL MODE: LED COLOR RED

1. PWM Control Input (port 2): the red LED will flash once and become solid.
2. Spektrum® Satellite Receiver inserted (port8/9): the red LED will flash twice and become solid.

ANGULAR VELOCITY MODE: LED COLOR BLUE

1. PWM Control Input (port 2): the blue LED will flash once and become solid.
2. Satellite receiver inserted (port8/9): the blue LED will flash twice and become solid.

SPARE PARTS LIST

BLH7901	Main Control Board w/ RX: 350 QX2
BLH7902	White Battery Cover: 350 QX2
BLH7903	Battery Frame: 350 QX2
BLH7904	Gimbal Arms: GB200™
BLH7905	Gimbal Motors: GB200™
BLH7906	Gimbal Mount: GB200™
BLH7907	Gimbal Control Board: GB200™
BLH7908	Camera mount CGO1™: GB200™
BLH7909	Camera mount Go Pro Hero 3®: GB200™
BLH7910	GB200™ Brushless Gimbal

TROUBLESHOOTING GUIDE

WHAT	WHY	SOLUTION
The gimbal keeps vibrating after initializing.	Camera may not be mounted securely to the camera mount.	Check and make sure camera is mounted completely and securely in the camera mount. Camera needs to be pressed into the Camera mount completely; otherwise, the center of gravity will be incorrect.
The gimbal does not function or respond.	Gimbal may have been moved during initialization.	Cycle the gimbal power on/off by switching model on/off.

Gimbal will not power on.	Gimbal control harness may not be connected into the correct port.	If using GB200™ with Blade® 350 QX2, be sure to connect the control harness to the camera pitch control port . If using with any other model, be sure to connect PWM input to port the universal PWM input port and mode control port
Gimbal does not respond to control inputs and LEDs are glowing solid RED and BLUE.	Gimbal may not have positive connection via control harness or satellite receiver.	Check gimbal control harness/satellite receiver for a solid connection. Try disconnecting and reconnecting the control harness/satellite receiver and cycling the power on/off.
Red LED on gimbal flashes slowly and gimbal is inoperable.	The gyro board harness may have disconnected from the GB200™ control board.	Check the connection between the gyro board and the GB200™ control board.

LIMITED WARRANTY

YUNEEC™ warrants that for a period of (90) days from original date of purchase, the product will be free from defects in materials and workmanship under normal use. In the event of a defect, please contact YUNEEC customer Support (www.Yuneec.com) for assistance. YUNEEC's sole obligation under this warranty will be, at its option, to repair or replace the product. This warranty does not apply to products damaged by misuse, accident, or normal wear and tear and water damage. All implied warranties of merchantability or fitness for a particular purpose are limited to the duration of this warranty. YUNEEC™ disclaims all other expressed or implied warranties or conditions. to the extent not prohibited by law, in no event will YUNEEC™ be liable for any loss of revenue or profit, or for any special, indirect, consequential, incidental or punitive damages, however caused, arising out of or related to the use of or inability to use the product, even if YUNEEC™ has been advised of the possibility of such damages. In no event will Yuneec™ liability exceed the amount paid by you for the product. Some jurisdictions do not allow limitations on how long an implied warranty lasts, or the exclusion or limitation of incidental or consequential damages, so the above limitations or exclusions may not apply to you. This warranty gives you specific legal rights, and you may also have other rights, which vary by jurisdiction.

YUNEEC™

BLADE®

Copyright 2014 Yuneec International Co., Ltd.. / Horizon Hobby, LLC