

HM-650

High-Resolution Digital Music Player



Customer Service: 201-HIFIMAN (443-4626)
customerservice@hifiman.com
www.hifiman.com

 facebook.com/hifimanelectronics

 twitter.com/hifimanofficial



Owner's Guide
HIFIMAN

Disposal and Recycling Information

HM-650 Disposal and Recycling:

Dispose of your HM-650 according to your local environmental laws and regulations. The disposal of your HM-650 should be separated from household waste because the player contains electronic parts and battery.

When your HM-650 reaches its end of life, please contact your local environmental department for disposal and recycling information or you could simply send it back to us. The battery will be removed and recycled without causing pollution.

European Union—Disposal information:



This symbol means that according to local laws and regulations your product should be disposed of separately from household waste. When this product reaches its end of life, take it to a collection point designated by local authorities. Consumers can be punished by penalty for inappropriate disposal of electronic device. The separate collection and recycling of your product at the time of disposal will help conserve natural resources and ensure that it is recycled in a manner that protects human health and the environment.

This Owner's Guide is current at the time it was printed.

As there will be frequent updates to the player's firmware, check for updates often for best operation.

See more updated information on <http://www.hifiman.com/>.

1 HM-650 Basics	01	2 Operation	08
Function Buttons	02	Main Menu	08
Power ON/OFF key	03	SD Card	08
Accessories	04	Artist, Album and Genre	09
Using HM-650	05	All Songs	09
Note	05	Favorite	10
Card Installation	05	Delete a File	10
Power ON/OFF	05	Play Menu	11
Reset	06	Setting	11
Charging	06	System Version	11
Replacing the Battery	06	Repeat	12
Replacing the Amp Module	07	Shuffle	12
		Backlight	13
		Resume Playback	13
		Sleep mode	14
		Auto Power Off	14
		Brightness	15
		CUE Support	15
3 Other information	17	Language	16
HM-650 Service and Support	18	Updating Media Database	16
Recycling Information	19	Reset Settings	16



Specifications:

Dimensions:
 4.6"(117mm) W x 2.8"(72mm) D x 1.1"(29mm) H
Weight: 0.55 lb(250g)
Battery life: 9 hours
D/A Chip: WM8740
Frequency response: 20HZ-20KHz
Distortion: 0.008%(Line out)
S/N: 106±4dB
SD Card Memory: 128G
Acceptable music formats:
 MP3, ACC, WMA, OGG, ALAC (M4A)
 APE(16Bit/44.1KHz,48.0KHz,88.2KHz,
 96.0KHz,192.0KHz)
 16Bit & 24Bit:
 WAV, FLAC, AIFF (except 176.4KHz)

Do not use any chemicals or detergents to clean the player.

Do not plug any other device into the headphone output port except for headphones or earphones.

It is recommended not to use headphones while riding, driving or operating motor vehicles.

If you experience ringing in your ears, please reduce the volume or turn off your player.

HM-650 Service and Support

Please visit us at <http://www.hifiman.com/AboutUs/Warranty/> for warranty service and support.

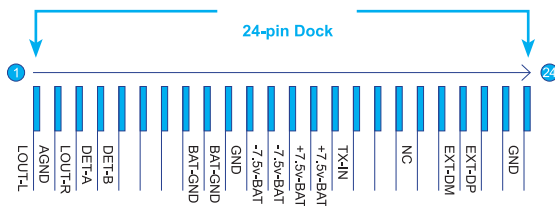

3 Other information

Product Safety

Note:

Make sure not to place heavy items on HM-650 to avoid possible damage to the player.

Be careful not to drop or hit your player.

Keep the player away from rain, water, drinks, chemicals and cosmetics, etc. Any damage caused by the player being soaked will not be covered in the warranty whether it is within or without the warranty period.

Avoid putting the player in a humid, dusty or smoky environment.

Any attempt to remove, repair or modify the player without permission is forbidden and will void the warranty.

Keep the player from direct sunlight. Proper operating environment: 21.2°F~104°F(-6°C ~40°C).

Function Buttons

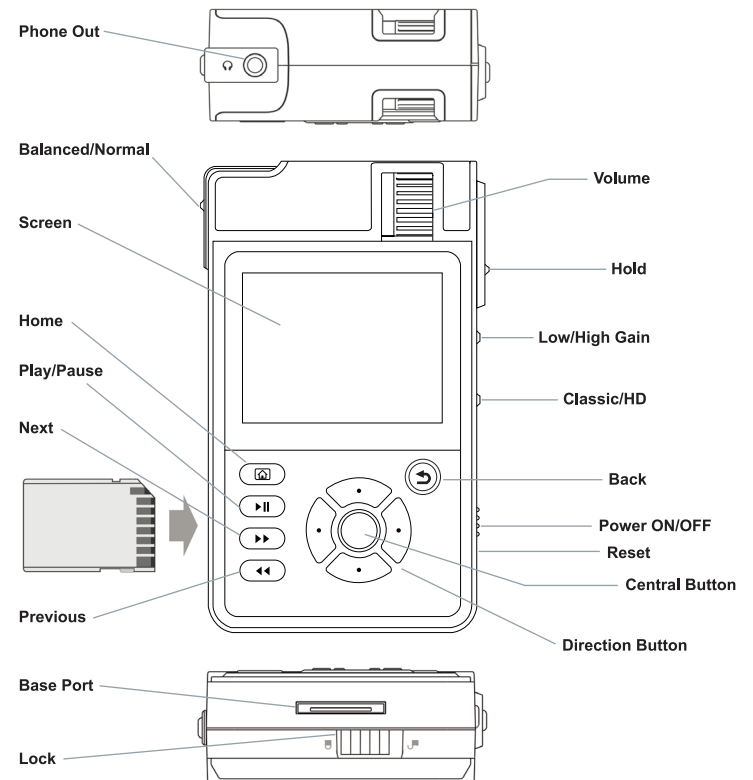

Power ON/OFF

Hold the power key up for 2-3 sec to turn on the player when HM-650 is powered off.

Hold the power key up for 2-3 sec to turn off the player when HM-650 is powered on. A dialog box will appear for you to select the mode.

Direction Button

The icon will show on the main menu after the player is powered on. In play menu, press the left/right button to fast forward/rewind; press the up/down button to play previous/next song.

Central Button

Press the central button in play menu to play music or pause.

Back

Press the button to return to the previous folder.

HOME

In play menu, press the HOME button to go to the main menu; press HOME again to return to play menu.

Play/Pause

After pressing the Play/Pause button, the player will play music or pause.

NEXT

Press the button to go to next song.

PREVIOUS

Press the button to return to previous song.

Language

On Main Menu, select "Setting" then go to "Language" to make your selection.



Updating Media Database

Refresh the files on the SD card and update the index information for all files in the data base.

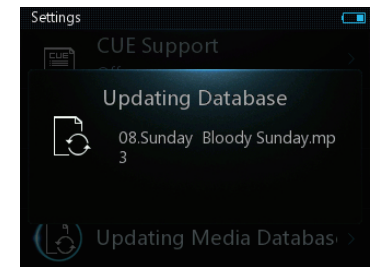
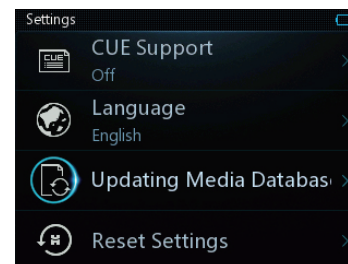

Reset Settings

Perform Factory Data Reset.

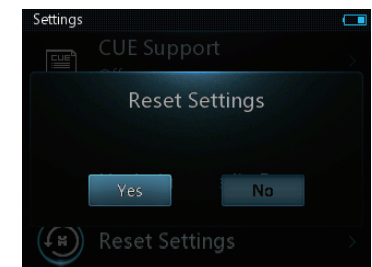

Warning: Performing a Factory Data Reset will clear the player's memory and put it back to the original factory default state.

Brightness

Set the display brightness from 1 to 5. Note: The brighter your display the more battery life will be affected.

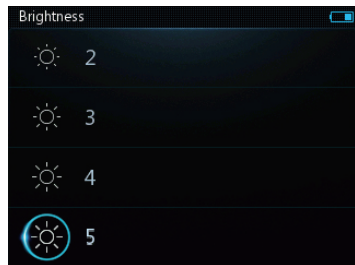
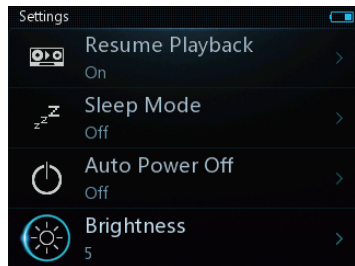

CUE Support

You can select to turn on/off CUE Support function.

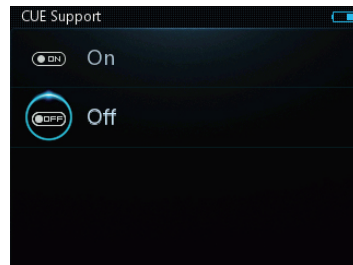

Low/High Gain

The player is set in Low Gain. Press the button to choose Low or High Gain.

Balanced/Normal

Phone output: Normal/Balanced. Select "Normal" for normal headphones or earphones but for balanced output, please select "Balanced".

Volume

Please turn the volume to "0" before playing music to protect your hearing. After the player is powered on, adjust the volume as you like.

HOLD

Press the HOLD button to lock or unlock the player. When the switch is set to hold, all the buttons (except for the volume button) are disabled. When the player is unlocked, all the buttons will once again be working.

Accessories

1. Line out cable with 3.5mm plug.
2. Charger, for charging HM-650.
3. Battery: Li-ion +7.4V 1600 mAh, -7.4V 500 mAh
4. Owner's Guide/Manual.

Using HM-650

Note

Please read this manual thoroughly on how to best install and operate your player for many years of enjoyment.

Card Installation

The HM-650 will automatically detect and update the files on the SD card after the player is turned on. The time for detection depends on the size of the files on the SD card. After the update, the HM-650 will be ready to play.

It is recommended that you install or remove the SD card when the player is powered off to prolong the life of the card and ensure the safety of those files.

Power ON/OFF

Hold the power key on the right side of HM-650 up for 2 sec. After releasing the power key, the player will power on and the HIFIMAN logo will appear.

With HM-650 on, push the power key on the right side of the player up. A dialog box will appear for you to select the mode: power off or cancel. If you select “power off”, the player will shut down.

Sleep Mode

On Main Menu, select “Setting” then go to “Sleep Mode” to set up the sleep function and desired amount of time. This function, and when it begins, is determined by when the user last operated the player.

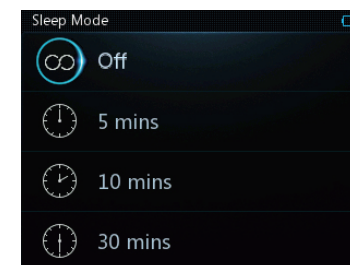

Auto Power Off

On Main Menu, select “Setting” then go to “Auto Power Off” to set the time desired. This function, and when it begins, is determined by when the user last operated the player.

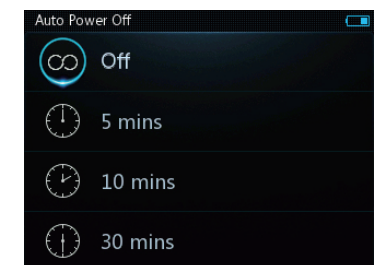

Backlight

You have the option to set the time for the player on as “always on, 10s, 30s, 1min and 2 mins”.

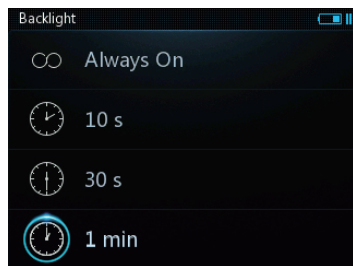
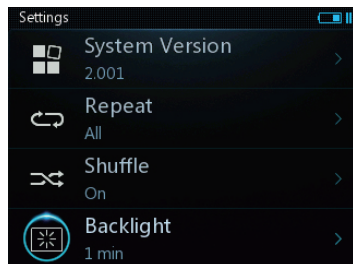

Resume Playback

On Main Menu, select “Setting ” then go to “Resume Playback” to turn on or turn off this function.

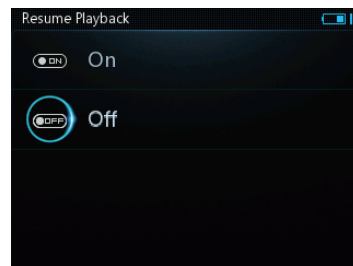

Reset

Should the player LCD become “frozen”, insert a fine-point pen or needle in the reset hole to reboot the player.

Charging

The average battery life of HM-650 is nine hours. Please charge the player when you see a reminder of low power. We recommend that you use the original HIFIMAN charger.

Note: The player can only be charged fully with Power OFF.

Replacing the Battery

How to remove the battery:

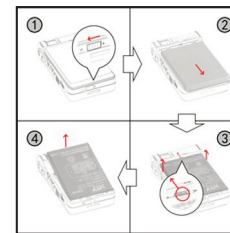

How to install the battery:

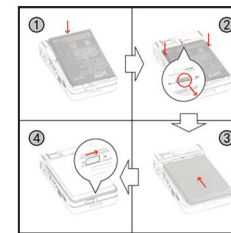

When your battery is out of life, you should replace it with a new one which can only be supplied by HIFIMAN or HIFIMAN authorized dealers. For more information on replacing the battery, please visit: <http://head-direct.com/>

Replacing the Amp Module

Please remove the battery first as instructed above. Then the amp module can be replaced. Several optional amplifier cards are available for your HM-650 to meet different needs. Below is a figure on how to replace the amp module:

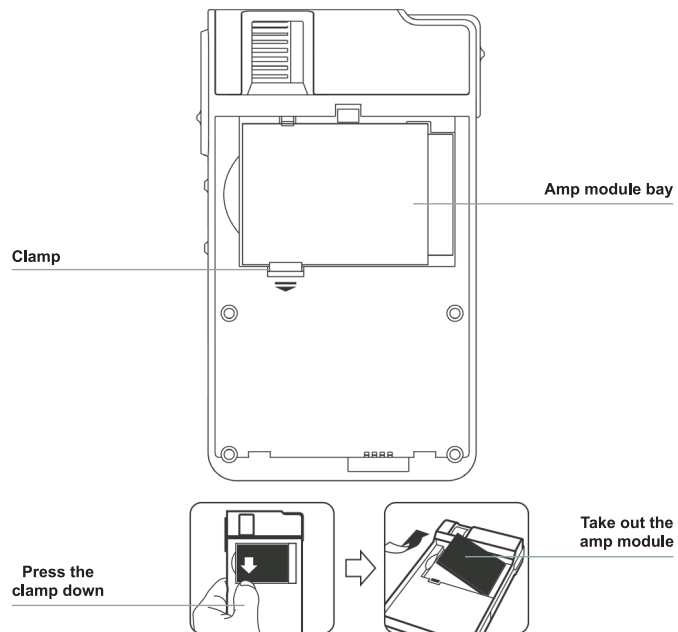

Please install the amp module in the opposite way of removing it.

Repeat

On Main Menu, select "Setting" then go to "Repeat" to make your selection.

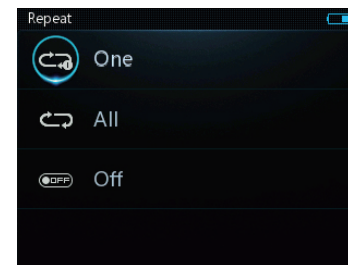
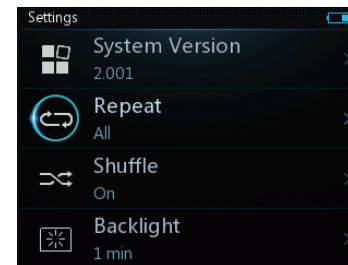

Shuffle

On Main Menu, select "Setting" then go to "Shuffle" to make your selection.

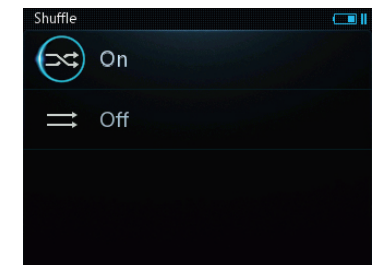
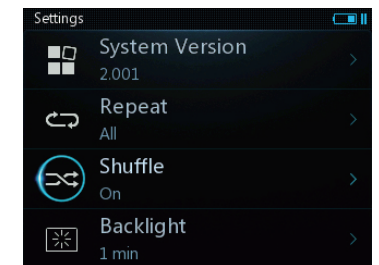

Play Menu

When play music, or select Now Playing, you will enter the interface below. You can press Central Button to pause/play music.



In player view, LONG PRESSING the Enter button will enable the Quick Setting Menu. In this menu, users can change the Repeat and Shuffle setting, and add/remove the playing track from favorite list. Users can also delete the playing track here.

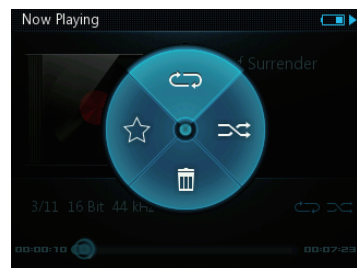

Setting

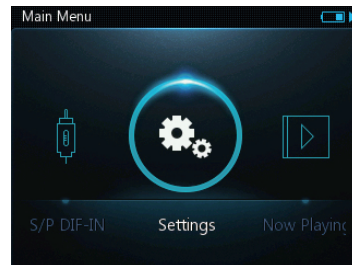

System Version

Click to see the information on your HM-650's current software version.

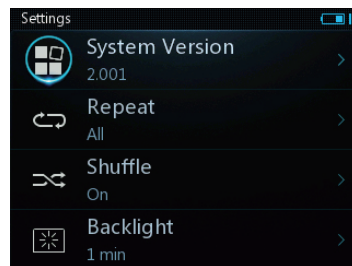

2 Operations

Main Menu

When the player is starting, the system will automatically detect the music files on the SD card and update database. After the update, the HM-650 will go to main menu.

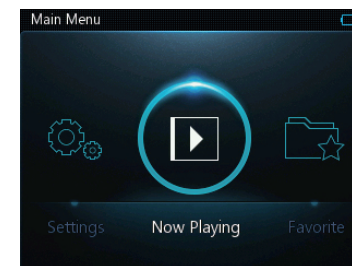
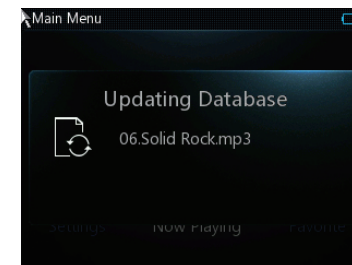

SD Card

On the main menu, rotate the wheel to SD card and click the central button to enter the SD card menu and view the music files. When the wheel highlights a single track, press the central button to play the song. By default, non-music files will not be visible.

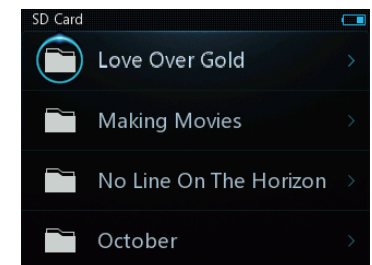

Artist, Album and Genre

After the player is started, the music files on the SD card are classified according to the artist, album and genre. Accordingly, three menus are shown on the main menu.

All Songs

After the player is started, you can go to “browse all songs” from the main menu and play music.

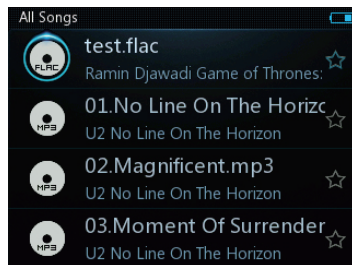

Favorite

When you browse all songs, you will view a hollow star following each song on the right. If you press the central button for several seconds, the song you are browsing will be added to “Favorite” with the star being solid. By entering Favorite from the main menu, you will see all the added songs.

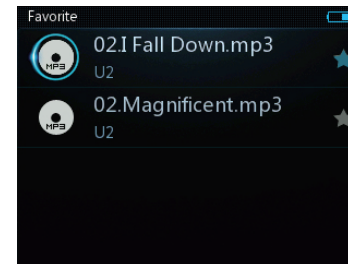

Delete a File

On the song list, press the Back button for seconds and a window will show up. Press Yes to delete the file you select. Note: Playing song can not be deleted.

