



STS-DT

Desktop Shooting Table

INSTRUCTIONS

Introduction

Thank you for choosing Impact.

The Impact STS-DT Desktop Shooting Table is designed for product photography and other still life. It comprises a collapsible metal frame and a glossy, translucent white plexiglass sheet. The plexiglass easily mounts to the frame to provide a seamless background. Two 7" legs make the STS-DT ideal for desktop use, and the compact frame and lightweight design make it easy to bring to locations for on-site shooting.

Precautions ⚠

- Please read and follow these instructions and keep this manual in a safe place.
- Do not attempt to disassemble or repair this product.
- Make sure that this product is intact and that there are no missing parts.
- To avoid damage to this product, be careful not to overtighten or improperly thread any of the threaded fittings.
- Do not collapse the metal frame while the plexiglass sheet is inside it.
- Be careful not to trap your fingers when collapsing the metal frame.
- All photos are for illustrative purposes only.

Contents Include

- Metal frame
- Plexiglass sheet
- Two (2) hooks
- Two (2) wing nuts
- User manual

Specifications

- Dimensions: 24" × 36"
(60 × 91 cm)
- Weight: 6.9 lb. (3.12 kg)

Assembling the STS-DT

1. Remove the plastic backing from the plexiglass sheet, and place it with either side facing up.
2. Unscrew the nut from one of the hooks, and insert the threaded tip of the hook into one of the holes on the bottom edge of the plexiglass sheet.
3. Screw the nut back onto the threaded tip of the hook. Make sure the hook is facing the inside of the plexiglass. **1**
4. Repeat steps 2 and 3 for the other hook.
5. Open the metal frame.
6. Place the plexiglass sheet onto the metal frame while inserting the top edge of the plexiglass into the clips at the top of the frame. **2**
7. Match up the holes in the plexiglass with the threaded posts in the frame.
8. Screw the wing nuts onto the threaded posts. **3**
9. Bend the bottom edge of the plexiglass sheet to secure the hooks under the front leg of the metal frame. **4**

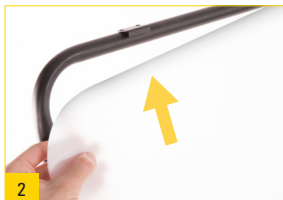
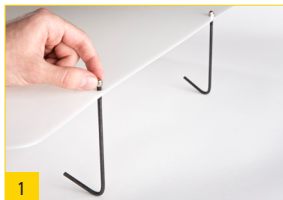

One-Year Limited Warranty

This IMPACT product is warranted to the original purchaser to be free from defects in materials and workmanship under normal consumer use for a period of one (1) year from the original purchase date or thirty (30) days after replacement, whichever occurs later. The warranty provider's responsibility with respect to this limited warranty shall be limited solely to repair or replacement, at the provider's discretion, of any product that fails during normal use of this product in its intended manner and in its intended environment. Inoperability of the product or part(s) shall be determined by the warranty provider. If the product has been discontinued, the warranty provider reserves the right to replace it with a model of equivalent quality and function.

This warranty does not cover damage or defect caused by misuse, neglect, accident, alteration, abuse, improper installation or maintenance. EXCEPT AS PROVIDED HEREIN, THE WARRANTY PROVIDER MAKES NEITHER ANY EXPRESS WARRANTIES NOR ANY IMPLIED WARRANTIES, INCLUDING BUT NOT LIMITED TO ANY IMPLIED WARRANTY OF MERCHANTABILITY OR FITNESS FOR A PARTICULAR PURPOSE. This warranty provides you with specific legal rights, and you may also have additional rights that vary from state to state.

To obtain warranty coverage, contact the Impact Customer Service Department to obtain a return merchandise authorization ("RMA") number, and return the defective product to Impact along with the RMA number and proof of purchase. Shipment of the defective product is at the purchaser's own risk and expense.

For more information or to arrange service, visit www.impactstudiolighting.com or call Customer Service at 212-594-2353.



Product warranty provided by the Gradus Group.
www.gradusgroup.com

IMPACT is a registered trademark of the Gradus Group.
© 2014 Gradus Group LLC. All Rights Reserved.