

impact™

lighting equipment and accessories



LiteTrek 4.0 Flash Tube
INSTRUCTIONS

Caution

The charge in the flash unit must be discharged before removing the flash tube. Make sure the flash unit is on. Push the TEST button on the rear panel of the flash. The unit will flash, discharging the power. Immediately turn off the power switch on the rear panel. Unplug the power cord from the power source.

- Never touch the flash tube immediately after use.
Wait at least 30 minutes for the tube to cool down.
- Never touch the flash tube with bare hands.
The oils on your hand can shorten the life of the flash tube.
- Only use the supplied or replacement flash tubes.
- Replace the flash tube if it is fractured, uneven, or discolored.

Flash Tube Replacement

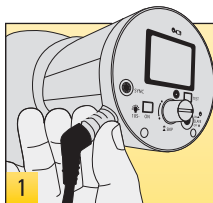

1 Turn off and disconnect light from the power supply. Remove the reflector.

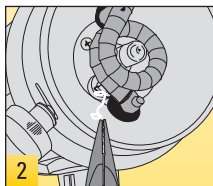

2 Using needle-nose pliers, unwrap the retention wire that is wrapped around the hook below the flashtube.

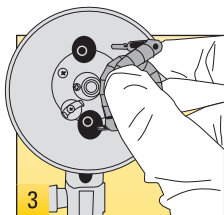

3 Using cotton gloves, gently lift and remove the old flash tube from its socket with one hand, while holding the light with the other hand.

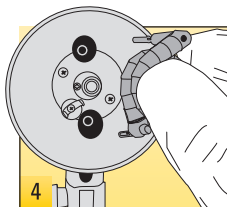

4 Insert a new flash tube by aligning the tube's pins with the light's socket.

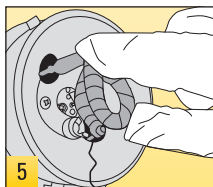

5 Push the pins of the flash tube into the sockets using firm but even pressure.

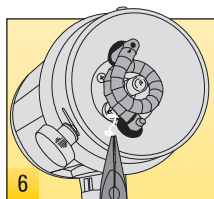

6 With needle-nose pliers, hook the retention spring over the hook below the flash tube.

Warranty

Impact provides a limited warranty that this product is free from defects in materials and workmanship to the original purchaser under normal use for a period of one (1) year from the original purchase date. Impact's responsibility with respect to this limited warranty shall be limited solely to repair or replacement, at its option, of any product which fails during normal consumer use. This warranty does not extend to damage or failure which results from misuse, neglect, accident, alteration, abuse, improper installation or maintenance. To obtain a replacement during the time of this warranty, please return the defective item with proof of purchase along with an RMA number to the place of purchase. This warranty gives you specific legal rights, and you may also have other rights which vary from state to state.

©Copyright 2010 Impact

For our other lighting equipment,
please visit our website

impact™

www.impactstudiolighting.com