

USER NOTICE

- ① Do not exceed the maximum specified load capacity [see specifications on the package label or visit www.indurogear.com]
- ① Always ensure that leg and head locks are tightly engaged before mounting a camera on the tripod
- ① Always clean and dry the tripod after it has been exposed to wet, dusty, sandy or salty conditions. Your tripod is not recommended for use in salt water. If required clean tripod using a mild soap solution applied with a soft cloth and follow by wiping down with fresh water. Remove any dust, dirt or sand from all leg locks, leg lock levers, leg sections and all moving parts.
- ① Do not leave the product in the sun for prolonged periods and avoid high temperature exposure
- ① Avoid leaving the tripod unattended in areas where people could trip over the tripod and get hurt
- ① Remove camera, lens, and all gear from the tripod when transporting the tripod
- ① For your safety, don't let your Induro tripod come in contact with any electrical power source

Specifications and design are subject to change without notice.

INDURO®

INDURO Camera Support Gear | 75 Virginia Road, North White Plains, NY 10603 | T 914-347-3300 | F 914-347-3309 | info@indurogear.com | www.indurogear.com

INDURO®

ADVENTURE AK-SERIES TRIPOD KIT OPERATING INSTRUCTIONS

Thank you for making Induro your choice for professional photographic gear. Your Induro gear is manufactured to provide years of dependable service. In order to obtain optimum satisfaction and performance we suggest that you carefully read these instructions and provide them to anyone who may also use your Induro gear.

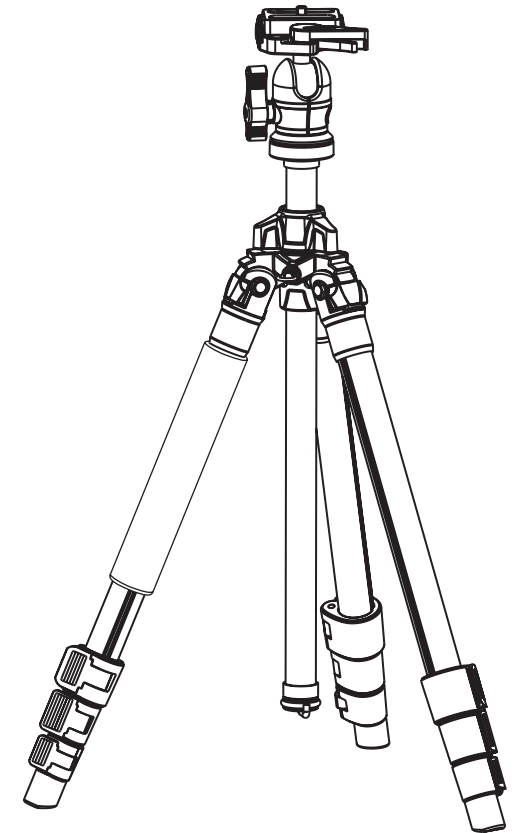

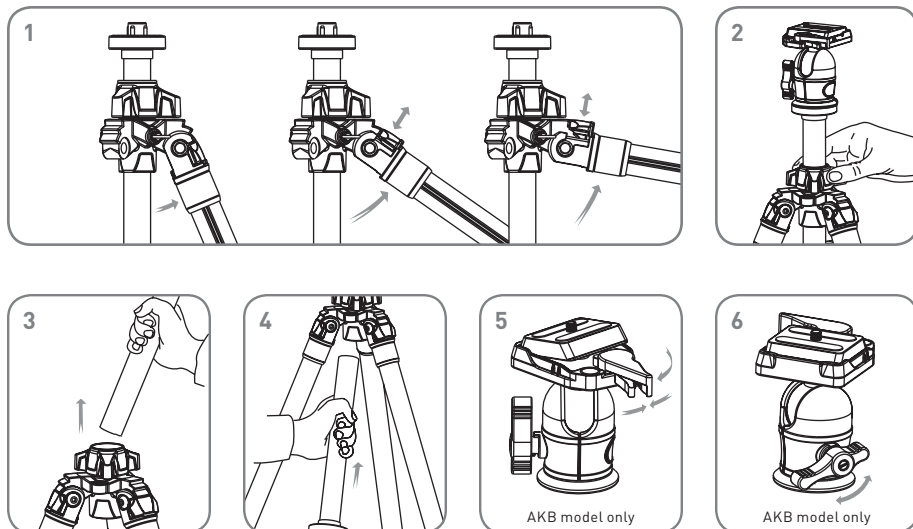
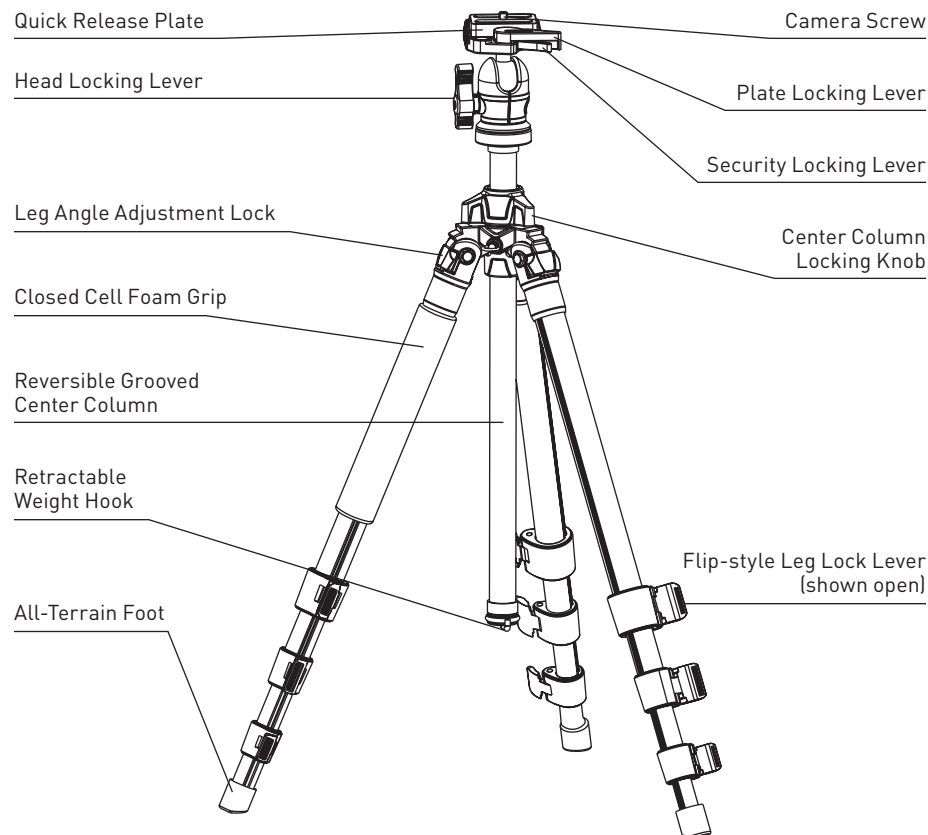

OPERATION

To use your tripod, swing all three legs out until they stop at the first locking point. While holding upper Leg Section, grab flat part of Leg Lock and flip out to unlock and release tension on Leg Sections. Slide Leg Sections out to achieve desired length (tripod height) and then close Leg Locks firmly to secure each Leg Section in place. Ensure that the tripod is firmly resting on a level surface. Tighten Mounting Screw on Quick Release Plate into the threaded tripod mount on the base of your camera or lens and then snap-in securely on the Tripod Head. Always press Plate Locking Lever in firmly and engage any safety locks on the Tripod Head to prevent any accidental dismounting. While holding the camera loosen the Head Locking Lever and orient camera to desired shooting position and then tighten Head Locking Lever.

FOR BEST RESULTS: Do not raise the tripod taller than necessary and extend largest diameter Leg Sections first. Only extend Center Column if required to reach maximum height or to fine tune vertical position.

NOTE: Never carry your tripod with camera gear attached.

Leg Angle Adjustment (FIGURE 1)

To accommodate uneven terrain, awkward shooting situations or for low angle shooting, your Induro tripod includes a 3-position leg angle adjustment sliding lock. Each leg can be independently adjusted by pulling the sliding leg angle lock out and selecting one of the three step positions (24, 55 or 80 degrees). Ensure that the leg angle lock is securely pushed back into the lock position after you have selected the desired leg angle.

Leg Section Adjustment (MAIN FIGURE)

Each leg section can be independently adjusted to the desired length by pulling open the Flip-style Leg Lock Levers. Once unlocked the leg is free to slide in or out to adjust to the desired length. Close the Flip-style lever securely to clamp and lock the leg. Repeat this step for each leg and each section until the tripod is set to the desired height.

NOTE: To prevent any accidental damage to your gear, always remove any mounted equipment (camera, etc) from the tripod before adjusting the leg sections.

Raising and Lowering the Center Column (FIGURE 2)

To raise or lower the center column, turn the center column locking knob counter-clockwise and slide the column to the desired position. While holding the column in position, turn the column locking knob clockwise to secure the column in place. Don't over tighten the center column lock, as this could damage the threads.

NOTE: Take special care when raising or lowering the center column, if a camera or equipment is mounted on the tripod. Never loosen the center column lock without holding the center column. Failure to follow these instructions could result in damaged equipment.

Reversible Center Column (FIGURES 3 & 4)

Your tripod offers the ability to reverse the Center Column for close-up photography, copy work and for difficult to reach objects. To reverse the Center Column, unscrew the Weight Hook located on the bottom of the Center Column. Loosen the Center Column Locking Knob and pull the Center Column out. Insert the Center Column with the mounting plate upside down and retighten the Center Column Locking Knob securely. The Center Column has a grooved slot to prevent unwanted rotation. Be sure to line-up the groove with the key before inserting the column back into the main casting.

NOTE: Do not reverse the Center Column when a camera or equipment is mounted.

TRIPOD HEAD OPERATION

AKP ADVENTURE TRIPOD KIT – Please refer to the separate PHT 3-Way Panhead operating instruction.

AKB ADVENTURE TRIPOD KIT – the following instructions apply to the Ballhead operation.

Quick Release Plate

The Adventure Series Ballheads incorporate a Quick Release Plate system. It offers a quick method of attaching and removing a camera or equipment from the tripod head. Extra plates are available separately so you can screw one to each camera or lens for even greater convenience when rapidly mounting and dismounting gear from your tripod.

Quick Release Locking Lever (FIGURE 5)

A patented dual lock quick release system when used properly offers two levels of security for your gear. To remove the Quick Release Plate, squeeze both the Security Locking Lever and the Plate Locking Lever, and pull the larger Plate Locking Lever out. The Quick Release Plate will disengage so it can be removed. To reconnect the Quick Release Plate, insert the angled part of the plate into the groove on the opposite side of the Locking Lever and press down flat. The locking levers will automatically engage the locking system and the locking levers will return to the safety lock position. Press the Plate Locking Lever in firmly to secure.

Head Locking Lever (FIGURE 6)

The single action ball-locking lever controls all movements of the ballhead. When released the head and the camera mounting platform can move freely providing 90-degree angular and 360-degrees rotational adjustment on the tripod platform.