



On-camera Field Monitor

Model No.: M701H

User Manual

Contents

Welcome.....	02
FCC Notice.....	03
Disposal Notice.....	03
Precaution.....	03
Package Contents.....	07
Main Features.....	08
Parts & Functions.....	09
Get Started.....	11
● Install Sun-Hood.....	11
● Open/Close Sun-Hood.....	11
● Install Battery Plate.....	12
● Connect DC Power Supply.....	13
● Fix HDMI Connector.....	14
Menu Tree & Adjustment.....	15
Menu Operations.....	15
● Picture.....	16
● Color.....	17
● F KEY.....	18
● FUNCTION.....	19
● OSD.....	23
Specifications.....	24
Customer Support.....	25
Warranty Card.....	26

Welcome

Thank you for your choice of our Filed Monitor. This high-tech while easy to use monitor can better your photography journey.

We recommend reading this manual first to get the best out of this unit.

FCC Notice (Federal Communications Commission)

This equipment has been tested and found to comply with the limits for class A digital device, pursuant to part 15 of the FCC rules. These limits are designed to provide reasonable protection against harmful interface when the equipment is operated in a commercial environment.

This equipment generates, uses and can radiate radio frequency energy. If not installed and used in accordance with the instruction, it may cause harmful interference to radio communication. However, there is no guarantee that interference will not occur in a particular installation. If this equipment does cause harmful interference to radio or television reception, which can be determined by turning the equipment on the off, the user is encouraged to try to correct the interference by one or more the following suggestion.

- Reorient or relocate the receiving antenna.
- Increase the distance between the equipment and the receiver.
- Connect the equipment to a different power outlet other than the one where the receiver is connected.
- Consult an experienced television or radio technician for help.

Disposal of Old Electrical & Electronic Equipment

(Applicable in the European Union and other European countries with separate collection systems)

This symbol on the product or on its packing indicates that this product shall not be treated as household waste. Instead it shall be handed over to the applicable collection point for the recycling of electrical and electronic equipment. By ensuring this product is disposed of correctly, you will help prevent potential negative consequence for the environment and human health, which could otherwise be caused by inapposite waste handling of the product. The recycling of material will help to conserve natural resources.

Precaution

- Always use set voltage. (DC 6-12V)
- All operating instructions must be read and understood before the product is operated. These safety and operating instructions must be kept in safe place for future reference.
- All warnings on the product and in the instructions must be observed closely.
- All operating instructions must be followed.
- Do not use attachments not recommended by the manufacturer. Use of inadequate attachments can result in accidents.
- This product must be operated on a power source specified on the specification label.
- If you are not sure of the type of power supply used in your home, consult your dealer or local power company. For units designed to operate on batteries or another power source, refer to the operating instructions.

- The power cords must be routed properly to prevent people from stepping on them or objects from resting on them. Check the cords at the plugs and product.
- In case of using other 12V DC adapter instead of the standard adapter provided by the manufacturer, please check the proper load capacity (or current capacity) and use an adapter with stable voltage.
- Do not overload DC outlets or extension cords. Overloading can cause electric shock.
- Never insert an object into the product through vents or openings. High voltage in the product, and inserting an object can cause electric shock and/or short internal parts. For the same reason, do not spill water or liquid on the product.
- Do not attempt to service the product yourself. Removing covers can expose you to high voltage and other dangerous conditions. Request a qualified service person to perform servicing.
- If any of the following conditions occurs, unplug the power cord from the DC outlet, and request a qualified person to perform repairs.
 - 1) When the power cord or plug is damaged.
 - 2) When a liquid was spilled on the product or when objects have fallen into the product.
 - 3) When the product has been exposed to rain or water.
 - 4) When the product does not operate properly as described in the operating instructions. Do not touch the controls other than those described in the operating instructions.
Improper adjustment of controls not described in the instructions can cause damage, which often requires extensive adjustment work by a qualified technician.

- 5) When the product has been dropped or damaged.
- 6) When the product displays an abnormal condition, any noticeable abnormality in the product indicates that the product needs servicing.
 - In case the product needs replacement parts, make sure that the service person uses replacement parts specified by the manufacturer, or those with the same characteristics and performance as the original parts. Use of unauthorized parts can result in fire, electric shock and/or other danger.
 - Upon completion of service or repair work, request the service technician to perform safety checks to ensure that the product is in proper operating condition.
 - When mounting the product on a wall or ceiling, be sure to install the product according to the method recommended by the manufacturer.
 - Unplug the power cord from the DC outlet before cleaning the product. Use a damp cloth to clean the product. Do not use liquid cleansers or aerosol cleaners.
 - Unplug the power cord from the AC outlet if you do not use the product for considerably long time.
 - Do not use the product near water, such as bathtub, washbasin, and kitchen sink and laundry tub swimming pool and in a wet basement.
 - Keep the product away from direct rays of the sun-light.
 - Do not place the product on an unstable cart, stand, tripod or table. Placing the product on an unstable case can cause the product to fall, resulting in serious personal injuries as well as damage to the product. Use only a cart, stand, tripod, Plate or table recommended by the manufacturer or sold with the product.

When mounting the product on a wall, be sure to follow the manufacturer's instruction. Use only the mounting hardware recommended by the manufacturer.

- When relocating the product placed on a cart, it must be moved with the utmost care.
- Sudden stops, excessive force and uneven floor surface can cause the product to fall from the cart.
- The vents and other openings in the cabinet are designed for ventilation. Do not cover or block these vents and openings since insufficient ventilation can cause overheating and/or shorten the life of the product. Do not place the product on a bed, sofa, rug or other similar surface, since they can block ventilation openings. This product is not designed for built-in installation; do not place the product in an enclosed place such as a bookcase or rack, unless proper ventilation is provided or the manufacturer's instructions are followed.
- In case of installation the product on the rack, the inside of the product would be overheated due to heat from other devices near by and the decrease of air circulation, which could damage to the monitor. To prevent the damage, please have enough space for the monitors and use fan to avoid heat and maintain the operating temperature. (refer to the specification of the product).
- The LCD panel used in this product is made of glass. Therefore, it can break when the product is dropped or applied with impact. Be careful not to be injured by broken glass pieces in case the LCD panel breaks.
- Keep the product away from heat sources such as radiators, heaters, stoves and other heat generating products (including amplifiers).

Package Contents



M701H Field Monitor

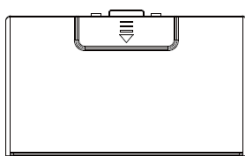

Sun-Hood



Tripod Ball Head

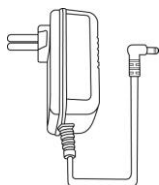

DC Power Adaptor



HDMI Cable

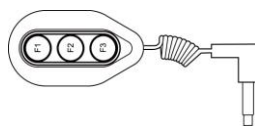

External Self-define
Button Plate

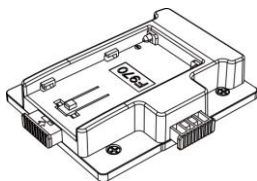

Battery Plate
F970

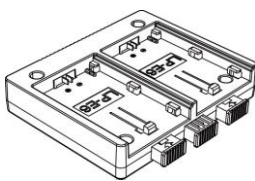

Battery Plate
LP-E6
(optional)

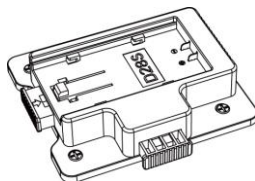

Battery Plate
D28S
(optional)



User Manual

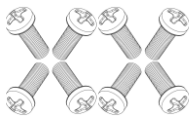

Screws (8pcs)



Carry Bag
(optional)

Main features

- **All-in-one type system**

Slim and slim-in-one type monitor.

- **HDMI Input**
- **HDMI Output**
- **YPbPr**
- **Tally**

- **Wide screen / wide viewing angle, 1280*800, 800:1**

- **Focus Assist**
- **False Color**
- **Exposure**
- **7 Scale mode**
- **Over-scan**
- **Pixel to Pixel**
- **H/V Delay**
- **Zoom**
- **Black and White**
- **Blue only**

- **Audio out**

- Internal speaker / Stereo audio out through phone jack.

- **Unique Sun-Hood**

- Very easy to install/uninstall, open/close

- **Camera Button**

- No black screen when video recording started; No distortion; Display size maximized.

- **Knob control**

- Easy to adjust user configuration by using the control knob.

- **Self-define Button**

- Helps to define regularly-used function!

- **Fit Markers**

- Center marker, safety area marker, aspect marker, display size (scan)

- **Multiple Battery Plate/DC**

- Easy to install/uninstall

- **Additional features**

Camera mounting Hole x 4,
7 OSD languages

Parts & Functions 1/2

FRONT/SIDE/TOP

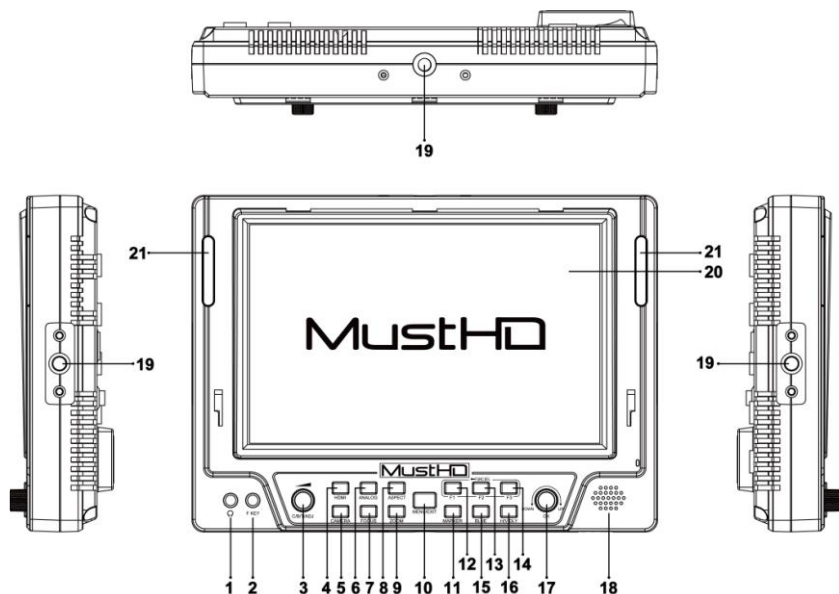

1	Earphone Jack	12	Self-define function Key#1
2	External self-define Function	13	Self-define function Key#2
3	Contrast/Brightness Adjustment	14	Self-define function Key#3
4	Choose HDMI as input Source	15	Blue only
5	Camera (see page22)	16	H/V Delay
6	Choose Analogue as input	17	Up/Down/Confirm
7	Focus Assist	18	Speaker
8	Aspect ratio adjustment	19	Fixing screw hole
9	Zoom	20	Sun-hood
10	Menu/Exit	21	Tally indicator
11	Fit Marker		

Parts & Functions 2/2

BOTTOM/ REAR

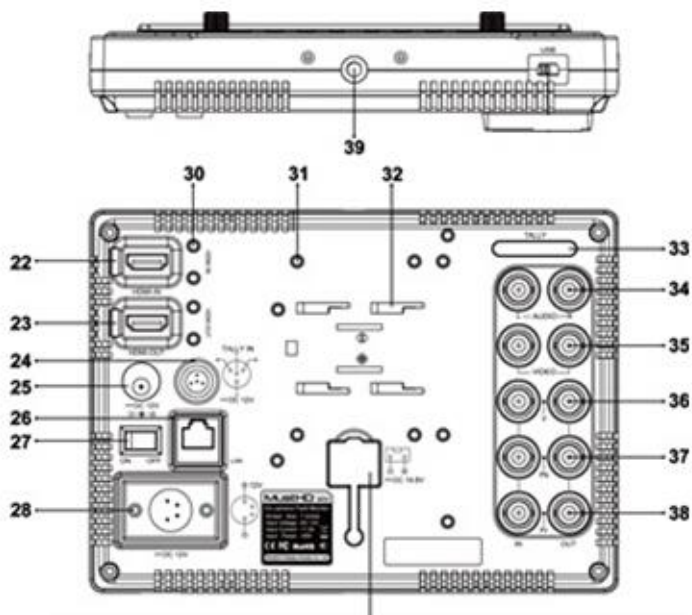

22	HDMI input	31	Battery plate fixing hole
23	HDMI output	32	Battery Plate lock grave
24	DC Power Input #1	33	Tally indicator
25	DC Power Input #2	34	Audio in
26	Tally input	35	Video in
27	Power on/off switch	36	Y
28	DC Power Input #3	37	Pb
29	DC Power Input #4	38	Pr
30	HDMI cable locker fixing hole	39	Fixing screw hole

Get Started

[1] Install Sun-Hood Cover to the Monitor

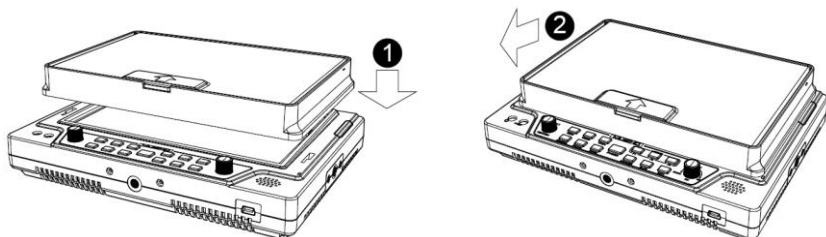

[2] Open / Close the Sun-Hood

Please follow the step sequence to open or close the hood!

Open the Sun-Hood

Close the Sun-Hood

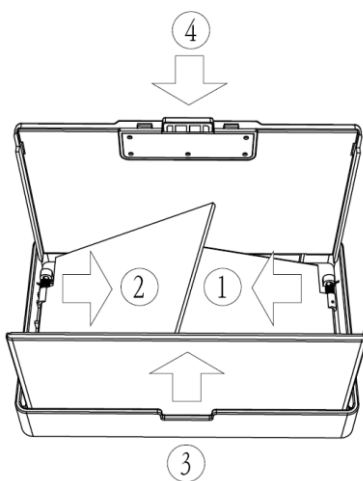
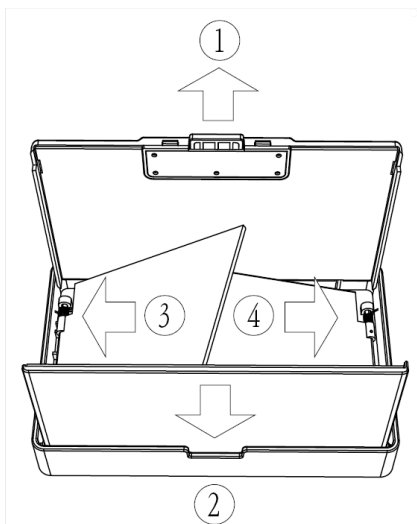

[3] Install Battery Plate on to the Monitor

The following illustration is based on LP-E6 battery. F970/ D28S are basically the same.

- 1) Put the Plate at the right position on the monitor back cover.
- 2) Slide it backwardly to the utmost.
- 3) If needed, use the four screws that come with the package to fix the Plate more tightly.

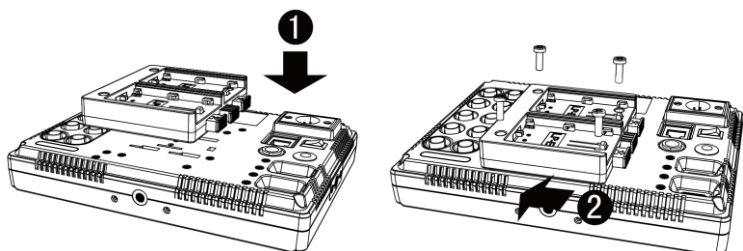

[4] Uninstall Battery Plate from the Monitor

The following illustration is based on LP-E6 battery. F970/ D28S are basically the same.

- 1) Press the lock button (do not release the press) while pushing the Plate outwardly.
- 2) Take it upwardly.

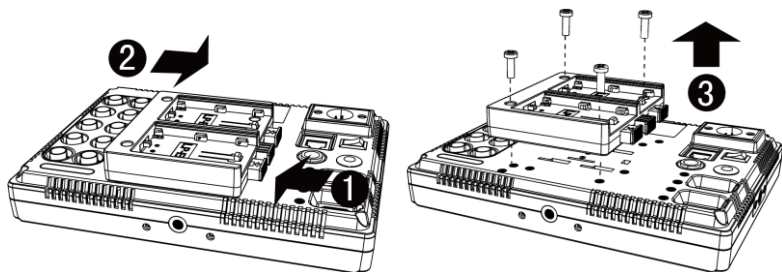

[5] Install Battery on to the Battery Plate

The following illustration is based on LP-E6 battery. F970/ D28S are basically the same.

- 1) Put the battery in right position on the Plate.
- 2) Push it inwardly to the utmost.

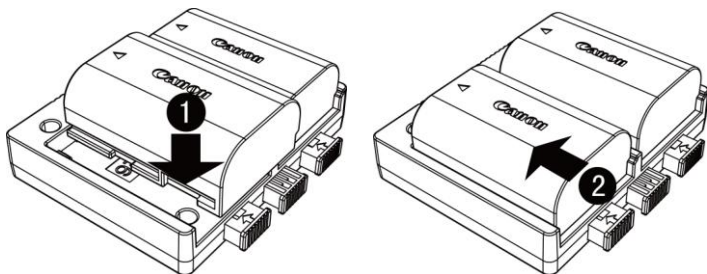

[6] Uninstall Battery from the Battery Plate

The following illustration is based on LP-E6 battery. F970/ D28S are basically the same.

- 1) Press the lock button inwardly (do not release the press) while pushing the battery outwardly.
- 2) Take the battery upwardly.

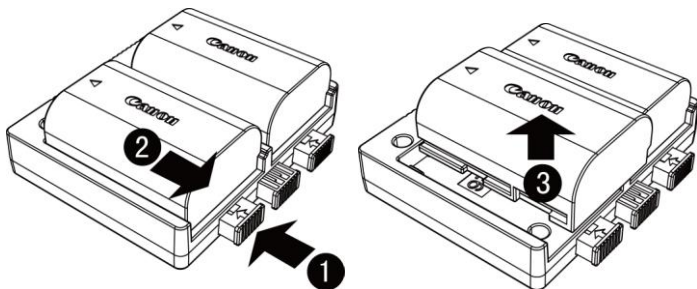

[7] Connect DC Power Supply from the Battery Plate

You can also use external DC power by using the adaptor that comes with the package. Please only use the adaptor that comes with the machine; otherwise there maybe potential risk.

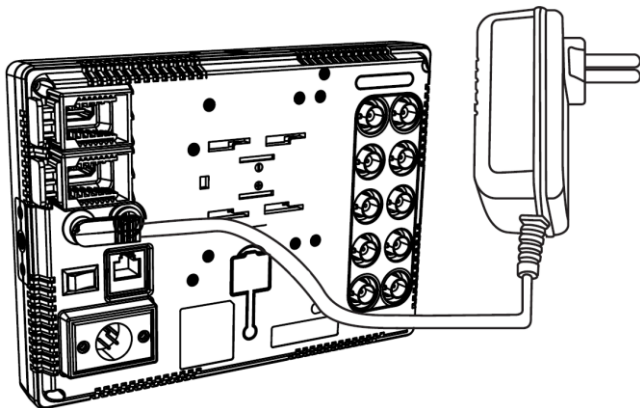

[8] Fix HDMI Connector

The uniquely-designed HDMI locking mechanism can eliminated accidental disconnection completely.

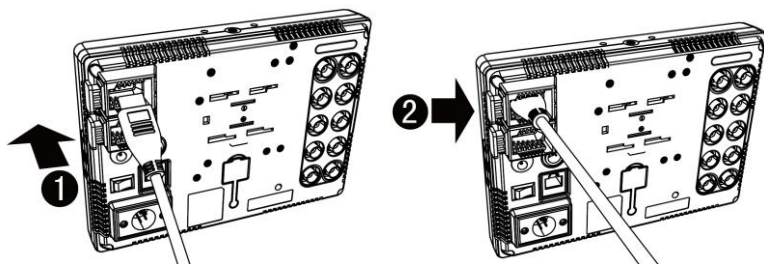

Menu Tree & Adjustment

[1] Menu Tree

OSD (On-Screen Display) Menu helps you use various functions. The following picture is the menu structure for M701H.



[2] Menu Control

User may control various functions using MENU button and Knob on the front side of the monitor.

[3] Menu Control Sequence

1. Press MENU button to activate the OSD menu.
2. Move to a desired menu by scrolling the Knob.
3. Press the Knob to select a menu and move to select a sub-menu by scrolling the Knob.
4. Press the Knob to select a desired sub-menu. (The selected sub-menu will be highlighted)
5. Press the Knob to save the new value after adjusting the value by scrolling the Knob.
6. Press MENU button to return to the previous menu and if there is no previous menu, the OSD menu will be removed from the screen.

Menu Operations

[1] Picture



- **Brightness**

-To set the brightness (=Offset) level from 0 to 100

#Press the knob to adjust brightness quickly.

- **Contrast**

-To set the contrast (gain) level from 0 to 100

#Press the knob to adjust contrast quickly.

- **Chroma**

-To set the saturation level from 0 to 100

#Press the knob to adjust chroma quickly.

- **Sharpness**

-To set the sharpness level from 0 to 100

#Press the knob to adjust sharpness quickly.

- **Volume**

-Used to set the volume level from 0 to 100

#Press the knob to adjust volume quickly.

[2] Color



• Color Temp

-Controls color temperature and allow instant access to preset color temperature settings.

-Available color temperature are 3200K, 5600K, 6500K, 9300K and User 1/2/3.

-In user 1/2/3 modes, user can define custom RGB GAIN and BIAS (=Offset) values.

• Gain Red/Green/Blue

-Used to set R/G/B Gain (or picture, contrast) level from 0 to 255.

Only available in User 1/2/3.

• Bias Red/Green/Blue

-Used to set R/G/B Bias (or Offset, mainly affects on black level) from 0 to 2047.

Only available in User 1/2/3.

[3] F KEY

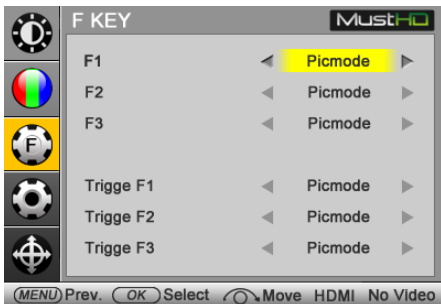

The F KEY function helps to self-define functions of the following keys:
F1/F2/F3 key on the front side the monitor
F1/F2/F3 key on the external self-define button plate

Steps to define the key function:

1. Press a button (F1, F2 or F3) for 3 seconds, and then the menu list will display at the right side of the screen.



2. Scrolling Knob Control up and down to choose the target function that you need to define to the button.
3. Press the Knob Control to confirm the selection.

[4] Function 1/2

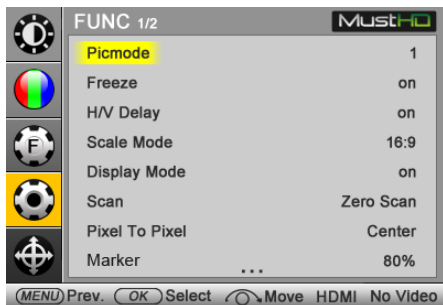

• User

This is to invoke a set of preset configurations.

• Freeze

Freeze or defreeze the current display by scrolling the Knob up and down

• H/V Delay

This is to select between Horizontal Half, Vertical Half or Quarter.

• Scale Mode

To set the display scale mode between auto, 16:10, 16:9, 15:9, 1.85:1, 2.35:1 and 4:3.

• Display Mode

Display or remove the input signal mark on the monitor.

• Scan

Open or close Overscan Mode by scrolling the Knob up and down.

- **Pixel To Pixel**

M701H monitor provides pixel count info by using Pixel to Pixel mode. When the resolution of the input video signal (ex. 1920x1080) is higher than that of the monitor (800*600), only area equivalent to 800*600 out of the 1920x1080 will be displayed in the [Pixel to Pixel] mode.

- **Marker**

Helps to activate or inactivate the Fit Marker function.

When the Fit Marker is activated, a border line of the Safety Area will be displayed inside the marker, Images below show the difference between Fit Marker ON and OFF.

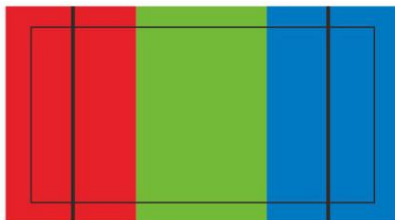

MARKER : 4:3
SAFETY AREA : 90%
FIT MARKER : OFF

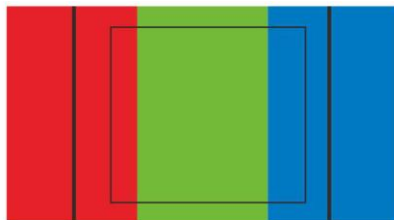

MARKER : 4:3
SAFETY AREA : 90%
FIT MARKER : ON

[4] Function 2/2

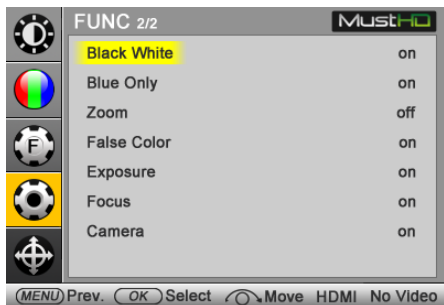

• Black White

Change the display to Black and White.

• Blue Only

Remove the red and green components from the input signal and display blue components only.

• Zoom

Used to magnify the image up to 90% on a pixel basis and is displayed on full screen.

• False Color

Help to open or close the false color function.

• Exposure

It superimposes red color over the on-screen image, indicating if an area of the shot is overexposed.

- **Focus Assist**

Help the shooters to easily find out the exact area in the picture with good focus, simply by adding sharp white lines on the shape or boundaries of the object in the picture.

- **Camera**

The advantage of switching to Camera mode (by pressing the button) is as follows:

- 1) Fully using the screen display, while removing the black area that can be seen at auto-mode.
- 2) No distortion.
- 3) No black clip when starting video record.

[5] OSD



- **Language**

Select the OSD language in the order of English/Germany/French/Spanish/Portuguese/Russian/Chinese.

- **H-Position**

Choose the horizontal position of the menu.

- **V-Position**

Choose the vertical position of the menu.

- **Duration**

Set the duration time of the menu on display.

- **Transparency**

Change the transparency level of the menu background.

- **System Default**

Change the system configuration back to default setting.

- **System Update**

Update the system through USB port.

Product Specifications

LCD	Size	7 inches
	Resolution	1280*800, support up to 1920x1080
	Pixel Pitch	0.039(H)x0.0.117(W) mm
	Color Depth	16.7M (8bit)
	Viewing Angle	H: 178 degrees V: 178 degrees
	Luminance of white	350 cd/m ² (Center)
	Contrast Ratio	800:1
	Display Area	149.76 (H) x 93.60(V)mm
Input Connector	5 x BNC	Analog Input
	1x HDMI	HDMI input
	1x LAN(RJ45)	TALLY
Output	5 x BNC	Analog Output
	1x HDMI	HDMI Output
Input Signal	Analog	Video Y Pb Pr
	HDMI	480i/480p/576i/576p/720p/1080i/1080p
Audio Out		Analog Stereo (phone jack) Internal speaker (Mixed Mono)
Power		DC 6-20V
Power Consumption		10 Watts (typical)
Operating Temperature		0°C to 45°C (32°F to 113°F)
Storage Temperature		-20°C to 60°C (14°F to 140°F)
Main Body Dimension (mm/inch)		197.5x143.6x50.6 / 7.78x5.65x1.99
Weight		766g / 1.69lbs

WEEE Directive & Product Disposal



At the end of its serviceable life, this product should not be treated as household or general waste. It should be handed over to the applicable collection point for the recycling of electrical and electronic equipment, or returned to the supplier for disposal.

Customer Support

For after sales service and tech support, please contact your local distributor or us by the following email:

support@musthd.com

On-camera Field Monitor (M701H)

WARRANTY CARD

Serial Number:		
Date of Purchase:		
Stamp and Signature of the Dealer		
Defect Description and Cause		
User's Info	Name:	
	Address:	
	Tel:	

放在底面，边上要有剪刀线