

VM-101

DSLR/VIDEO
MICROPHONE



POLSEN™

PRODUCT
MANUAL



CONTENTS

Introduction.....	3-4
Overview.....	5
Precautions	6
Installing the Battery.....	7
Mounting the VM-101.....	8-10
Recording with the VM-101.....	11-12
Specifications	13
Troubleshooting.....	14-15
One-Year Limited Warranty	16

DSLR/VIDEO
MICROPHONE
VM-101



THANK YOU FOR CHOOSING POLSEN.

The Polsen VM-101 is a sturdy directional condenser microphone that delivers high-quality sound to a DSLR camera, camcorder, or audio recorder.

Unlike omni-directional microphones built in to most cameras and recorders, the high-quality, directional condenser capsule of the VM-101 will decrease ambient noise while recording sound with greater clarity. The built-in wind screen will also minimize noise caused by moving air. Solid ABS construction and an integrated shock mount assure that sudden movements will not detract from the recording.

The VM-101 runs on a single AAA battery, and the compact, ultra-portable size, light weight, and included carry pouch make the VM-101 ideal for recording on the go. The integrated shoe-mount adapter fits any shoe-mount attachment, and the ¼"-20 threaded socket fits most boom poles. The VM-101 includes both a foam windscreen and fur wind cover for added protection against vocal plosives and wind noise when recording dialog.



Among the benefits you'll enjoy:

- Directional condenser microphone for high-quality sound
- Integrated shock mount to prevent noise due to moving or handling from being recorded
- Foam windscreen and fur wind cover to decrease vocal plosives and wind noise when recording dialog
- Compact ultra-portable design and carry pouch for easy transport
- 3.5 mm mini plug compatible with many makes and brands of DSLR cameras, video cameras, and audio recorders



OVERVIEW

1. Microphone barrel/wind screen
2. Battery compartment
3. ON/OFF switch
4. LED indicator
5. Shock mount
6. Mounting foot with locking wheel
7. Foam Windscreen
8. Fur wind cover
9. 3.5 mm mini plug connector

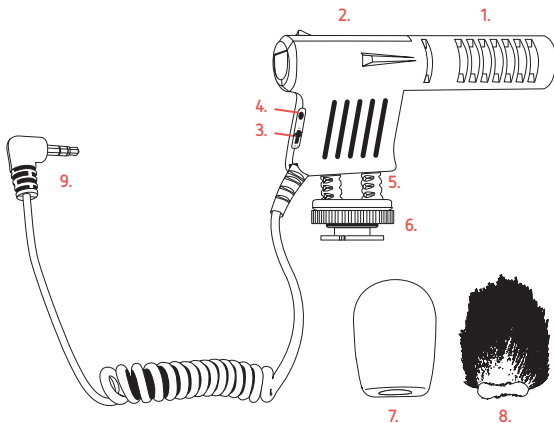

PRECAUTIONS ⚠

- Please read and follow these instructions, and refer to this manual in case of questions. Keep this manual in a safe place.
- Keep this product away from water and any flammable gases or liquids.
- Do not attempt to disassemble or repair the equipment yourself.
- Handle this product with care
- Clean the product with a soft dry cloth.
- Before use, make sure that this product is intact and that there are no missing parts.
- All photos are for illustrative purposes only.
- Do not leave the battery in this product for long periods of non-use. Batteries can leak and damage the microphone.

INSTALLING THE BATTERY

The VM-101 is powered by one AAA battery.

1. Remove the battery compartment cover by gently pressing on the arrows and sliding it toward the back of the microphone.
2. Insert an AAA battery making sure that the polarity of the battery matches the diagram inside the battery compartment.
3. Replace the battery compartment cover by sliding it back into position until it clicks into place.



MOUNTING THE VM-101

Shoe Mount

The VM-101 has a mounting foot and locking wheel for attaching to the shoe mount of a camera or camcorder.

1. Loosen the locking wheel of the shoe mount by turning it counterclockwise.
2. Securely hold the microphone and the camera.
3. Gently slide the microphone into the camera's shoe mount so that it is fully seated.
4. Tighten the locking wheel by turning it clockwise until the microphone is securely in place.



Mic Boom Pole

The mounting foot of the VM-101 comes with a threaded $\frac{1}{4}$ "-20 socket for attaching to a boom pole.

To attach to a boom pole:

1. Make sure the power on the VM-101 is turned off.
2. Position the microphone so that the threaded post at the end of the boom pole is aligned with the threaded socket on the VM-101.
3. Screw the boom pole into the threaded socket until the microphone is secure.



Making the audio connection

In order to record with the VM-101, it must be connected to a DSLR camera, camcorder, or recording device.

1. Make sure the power on the VM-101 is turned off.
2. Connect the VM-101 by plugging the 3.5 mm mini plug into the AUDIO IN jack of the camera or recorder.
3. If using a boom pole, you will need an extension cable (sold separately).

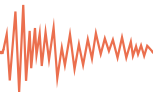

RECORDING WITH THE VM-101

Once the VM-101 is securely attached to the camera or recorder, turn the microphone on by moving the On/Off switch to the ON position. The LED indicator will turn on. The VM-101 is ready to record.

Note: The power switch of the VM-101 must be turned on in order to record.

Setting the Record Level on the Camera or Recorder

You may have to set the input level on your camera or recorder. Some DSLR, video cameras, and recorders allow the user to access the recording level via the device's menus. If you are setting the level manually, set the level so that the meter reads slightly below maximum level at the loudest points ("peaks") of your test audio. Consult the manual of your camera or recorder for more information.



Recording Tip: Before recording a complete take, it is always advisable to do a test recording and listen to the playback.

If the sound is too low, increase the mic gain (audio input level) on your camera or recording device. If there is no mic gain control, move the VM-101 closer to the sound source.

If the sound is too loud or is distorting during playback, decrease the mic gain (audio input level) on your camera or recording device. If there is no mic gain control, move the VM-101 further away from the sound source.

Using the Windscreen and Wind Cover

The foam windscreen should be used to minimize vocal plosives and breath noise for up-close microphone placement when recording speech or dialog. The fur wind cover should be used to eliminate noise from strong or gusting winds.



SPECIFICATIONS

MICROPHONE Condenser Microphone (Directional)

FREQUENCY RANGE 38 Hz - 20 kHz

SIGNAL-TO-NOISE RATIO 75 dB

SENSITIVITY -40dB \pm 3dB / 0dB=1V/Pa, 1 kHz

OUTPUT IMPEDANCE 1k Ohm or less

OUTPUT CONNECTOR 3.5 mm mini-plug

CABLE LENGTH **RELAXED** 8" (20.3 cm) **STRETCHED** 14" (35.6 cm)

OUTER CASE ABS Construction

POWER 1.5V AAA Battery (not included)

DIMENSIONS 4.3" \times 3.0" \times 1.8" (109 \times 75 \times 45 mm)

WEIGHT 1.8 oz (52 g)



TROUBLESHOOTING

Problem	Solution
No sound was recorded.	<p>Make sure that a fresh AAA battery is installed and correctly oriented in the battery compartment.</p> <p>Make sure the power switch on the microphone is set to the ON position and the LED indicator is on.</p> <p>Make sure the 3.5 mm mini plug is connected to the correct AUDIO INPUT jack on the device to which you are recording.</p>
The sound is distorted.	<p>Make sure the 3.5 mm mini plug is fully plugged into the audio input jack of your camera or recorder.</p> <p>If your camera or device has an input control, decrease the mic gain (audio input level) on your camera until the meter reads below peak level at the loudest point of the audio.</p> <p>Reposition the VM-101 further away from the sound source.</p> <p>(See: <i>Recording Tip</i> under <i>Recording with the VM-101</i>)</p>



Problem	Solution
The recording level is too low.	If your camera or device has an input control, increase the mic gain (audio input level) on your camera until the meter reads slightly below peak level at the loudest point of the audio. Reposition the VM-101 closer to the sound source. (See: <i>Recording Tip</i> under <i>Recording with the VM-101</i>)
The microphone is stuck in the camera's shoe mount.	Make sure the locking wheel is fully loosened. Important: the microphone should easily mount and dismount. Do not apply force by trying to pull the VM-101 off the camera. You could damage the microphone and the camera.

ONE-YEAR LIMITED WARRANTY

This Polsen product is warranted to the original purchaser to be free from defects in materials and workmanship under normal consumer use for a period of one (1) year from the original purchase date or thirty (30) days after replacement, whichever occurs later. The warranty provider's responsibility with respect to this limited warranty shall be limited solely to repair or replacement, at the provider's discretion, of any product that fails during normal use of this product in its intended manner and in its intended environment. Inoperability of the product or part(s) shall be determined by the warranty provider. If the product has been discontinued, the warranty provider reserves the right to replace it with a model of equivalent quality and function.

This warranty does not cover damage or defect caused by misuse, neglect, accident, alteration, abuse, improper installation or maintenance. EXCEPT AS PROVIDED HEREIN, THE WARRANTY PROVIDER MAKES NEITHER ANY EXPRESS WARRANTIES NOR ANY IMPLIED WARRANTIES, INCLUDING BUT NOT LIMITED TO ANY IMPLIED WARRANTY OF MERCHANTABILITY OR FITNESS FOR A PARTICULAR PURPOSE. This warranty provides you with specific legal rights, and you may also have additional rights that vary from state to state.

To obtain warranty coverage, contact the Polsen Customer Service Department to obtain a return merchandise authorization ("RMA") number, and return the defective product to Polsen along with the RMA number and proof of purchase. Shipment of the defective product is at the purchaser's own risk and expense.

For more information or to arrange service, visit www.polsenaudio.com or call Customer Service at 212-594-2353.

Product warranty provided by the Gradus Group.
www.gradusgroup.com



Polsen is a registered trademark of the Gradus Group. © 2014 Gradus Group LLC. All Rights Reserved.

