

- 1:** Position Shoe Clamp in camera shoe mount as shown and tighten screw.
 Note: Shoe Clamp MUST be placed so the free 1/4-20" mounting hole is nearest camera front.
- 2:** Remove standard mounting plate from camera. Replace with Redrock Micro DoubleTap as shown.

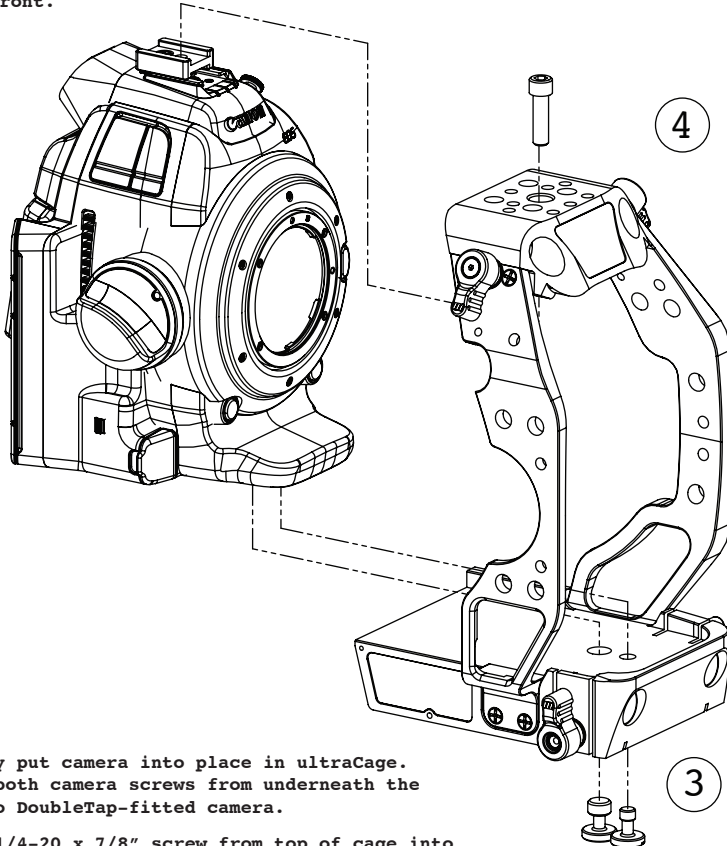

- 3:** Carefully put camera into place in ultraCage. Tighten both camera screws from underneath the cage into DoubleTap-fitted camera.
- 4:** Tighten 1/4-20 x 7/8" screw from top of cage into camera.