

Pro
Video
Stabilizer

REVO™



ST-1000

Thank you for choosing Revo and congratulations on your purchase of the Revo ST-1000 Pro Video Stabilizer. The Revo Pro Video Stabilizer is a compact, lightweight camera stabilization rig that uses counterbalance weights and a gimbal to help you keep your camera steady when shooting video—eliminating distracting camera movement for smoother, more professional-looking movies.

The ST-1000 can support a DSLR or camcorder weighing up to 4.85 pounds. A comfortable padded hand grip supports the camera mount. The universal camera mount is adjustable and has a quick-release mount. A super-smooth gimbal and adjustable counterweight help keep the camera balanced and stable. You can use the built-in bubble level to check the camera's balance at any time.



Components

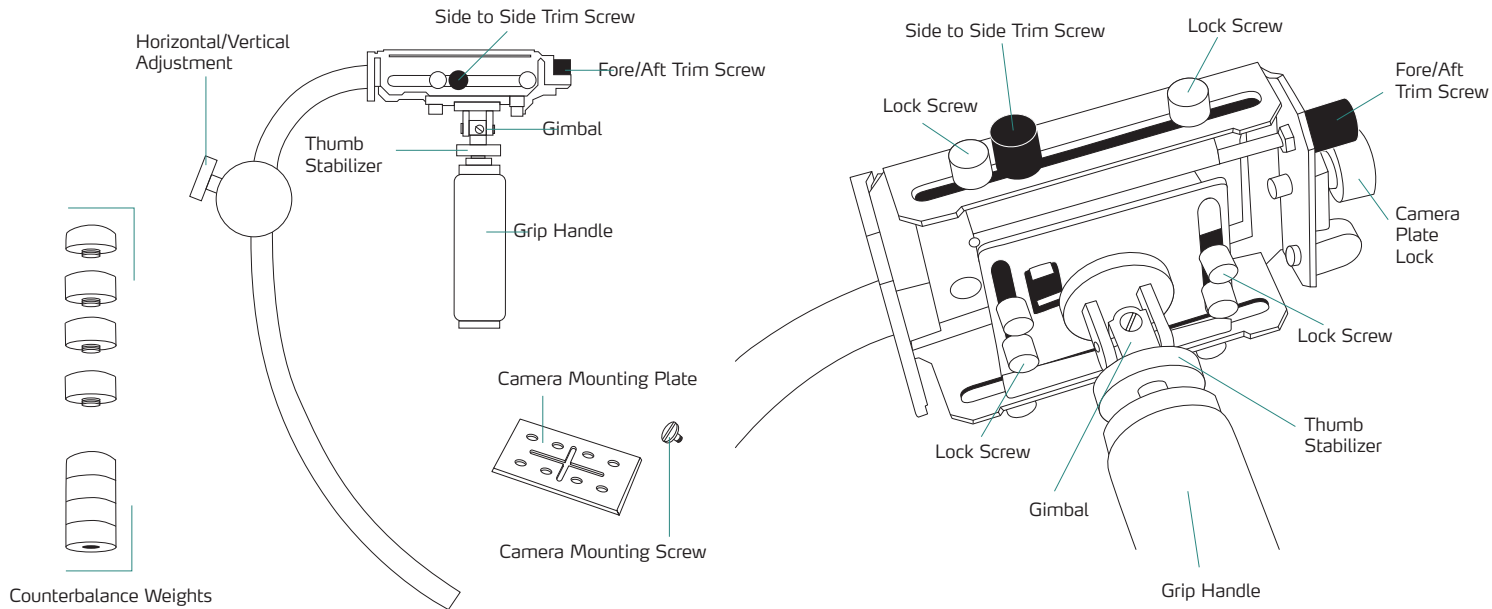

Warnings

- Please read and follow these instructions, and keep this manual in a safe place.
- Handle the unit with care.
- Clean the unit with a soft, dry cloth.
- Use only parts provided by the manufacturer.
- Make sure everything is secure before proceeding.
- Make sure the item is intact and that there are no missing parts.
- Do not exceed the maximum load capacity.
- All photos are for illustrative purposes only.

Limited One-year Warranty

Revo provides a limited warranty that this product is free from defects in materials and workmanship to the original purchaser under normal use for a period of one (1) year from the original purchase date or thirty (30) days after replacement (the "Warranty Period"), whichever occurs later. Our responsibility with respect to this limited warranty shall be limited solely to repair or replacement, at its option, of any product which fails during normal consumer use.

To obtain warranty coverage during the Warranty Period, contact your place of purchase ("Seller") to obtain a return merchandise authorization ("RMA") number, and return to Seller the defective product along with proof of purchase and the RMA number.

This warranty does not extend to damage or failure which results from misuse, neglect, accident, alteration, abuse, improper installation or maintenance. EXCEPT AS PROVIDED HEREIN, REVO MAKES NEITHER ANY EXPRESS WARRANTIES NOR ANY IMPLIED WARRANTIES, INCLUDING BUT NOT LIMITED TO ANY IMPLIED WARRANTY OF MERCHANTABILITY OR FITNESS FOR A PARTICULAR PURPOSE. This warranty provides you with specific legal rights, and you may also have additional rights which vary from state to state.

The ST-1000 Pro Video Stabilizer uses a gimbal device with a grip to keep the camera steady. The camera mount “floats,” anchored by the counterbalance weight at the end of the micro-adjustable counterbalance. Setting up this mechanism for the best results requires time and patience. Once it has been set-up properly, the settings can be recorded and used quickly without further set-up required. Always be sure to keep one hand on your camera when making adjustments, to prevent the camera from falling. Keep in mind that any professional technology requires practice and patience to master, with your results directly related to the time you devote to it.

Pre-Adjusting the Counterbalance Hinge

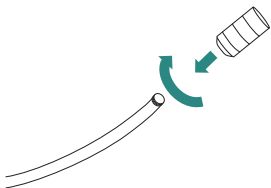

- 1 Attach the largest counter balance weight to the end of the counter balance extension. (After mounting the camera, smaller counterbalance weights may be added, if necessary.). It doesn't need to be overly tightened — just tight enough so that there's no play in the screw.

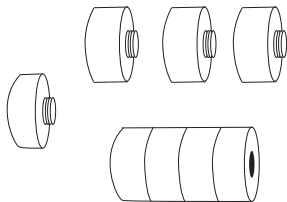

Note: There are five weights included with this stabilizer—one large weight and four small weights. You can use any one of these weights (including just a single small weight), or any combination of weights (including all of the weights) on the counterbalance extension to achieve the correct counterbalance for your camera.

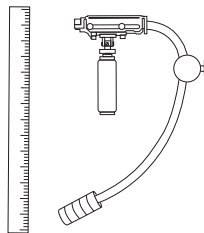

- 2 For the starting position, measure the counter balance hinge distance from the end of the weight on the hinge to the end of the camera mounting base.

1 lb. = 8 in.
+2 lb. = 12 in.

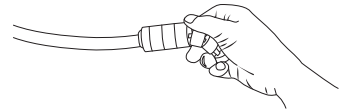
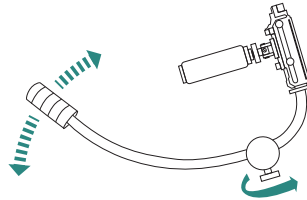

3 If your camera weighs approximately one pound (450 g), set the counter balance hinge distance to about 8 inches (23 cm). If your camera weighs two pounds or more, set the counter balance hinge distance to approximately 12 inches (30.48 cm).

4 You can adjust the vertical balance by turning the horizontal and vertical trim screw to open or close the counterbalance hinge.

5 Adding or subtracting counterbalance weight will also affect the balance. The correct balance should be slightly bottom-heavy.

Mounting the camera

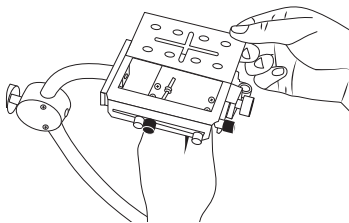

- 1** Remove the quick-release camera plate from the receiver mount.

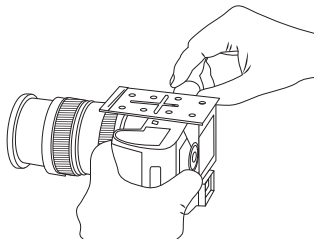

- 2** Using the included 1/4" mounting screw, attach the camera to the quick-release plate, and securely tighten the screw.

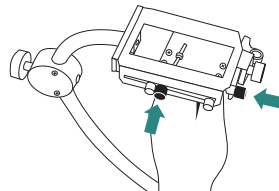

- 3** Check that the side-to-side trim screw and the fore-and-aft trim screw on the receiver mount are at their respective start points—the long screw controlled by the black knob on the mounting platform, in each case, should not extend past the sheath at the end of the screw.

Note: When mounting a DSLR camera with a heavy lens attached (such as a telephoto or zoom lens), move the plate forward in the direction of the lens as a starting point. When mounting a video camcorder, mount the plate so that it's centered or slightly forward of the center of the camera as a starting point. For purposes of balance, you can use any of the holes on the mounting plate for mounting the camera, in addition to the X slot.

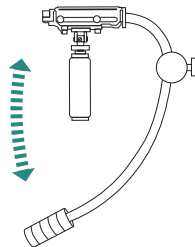
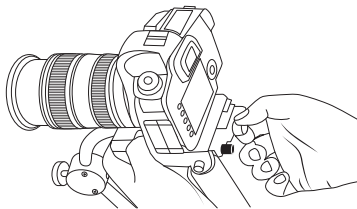
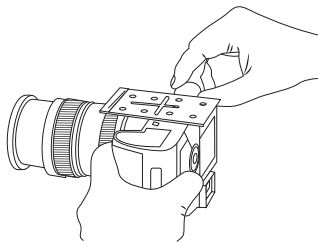

- 4 Remove the quick-release camera plate from the receiver mount.

- 5 Check that the side-to-side trim screw and the fore-and-aft trim screw on the receiver mount are at their respective start points—the long screw controlled by the black knob on the mounting platform, in each case, should not extend past the sheath at the end of the screw.

Note: The distance of the weight from the camera affects the balance, and can be adjusted using the horizontal and vertical trim screw to open or close the arc of the counterbalance hinge.

Adjusting Horizontal and Vertical Trim

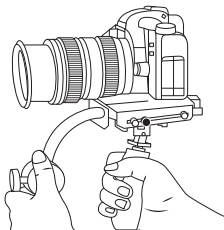

- 1 Gripping the handle with your camera mounted on the mounting platform, hold it up to see if it tilts to the left or to the right

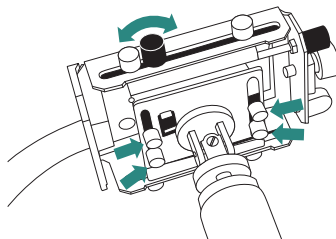

- 2 To make adjustments to the side-to-side placement of the camera, loosen the four silver screws on the bottom of the camera mount and use the black screw on the side of the mounting platform to adjust the side-by-side position of the camera. When you've achieved the best possible side-to-side balance, tighten the four silver screws on the bottom of the mount securely.

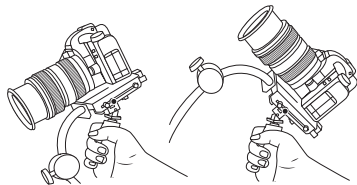

- 3** If the camera dips forward or backwards, you can make adjustments to the front-to-back position of the camera.

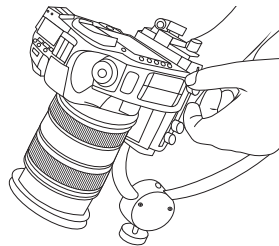

- 4** Loosen the two silver screws on the left side and the two silver screws on the right side of the mounting platform, then use the black screw at the back of the platform to move the camera forward or backward.

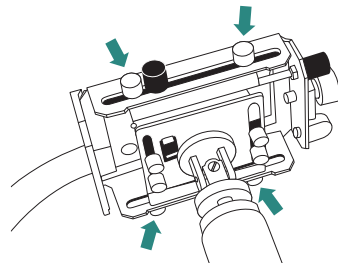

- 5** When you're finished, tighten the two silver screws on the right side of the platform and the two silver screws on the left side of the platform.

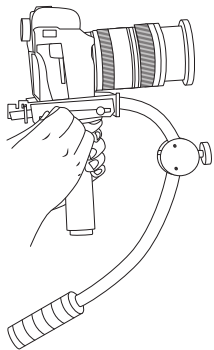

- 6** You may need to repeat each of these steps several times to achieve the correct balance. When you have the correct balance, note the weight you used, the distance that the counter balance hinge is open, and the position of the quick-release plate on the mounting platform. Then, you can easily use the same settings for every shoot.

Note: Once you've achieved optimal balance of your camera on the ST-1000, you will be able to pan or tilt the camera while shooting. To pan the camera, place the thumb of the hand supporting the ST-1000 on the control ring directly above the hand grip and below the receiver mount. Using your thumb, the knurled ring can be carefully turned to the left or to the right to pan the camera. To tilt the camera, put your thumb firmly against the bottom of the receiver mount between the two silver screws at the back of the receiver mount and the knurled ring attached to the bottom of the receiver mount. Apply pressure carefully to tilt the camera as desired.

When you're finished shooting, remove the camera and quick-release plate from the stabilizer. If the stabilizer is placed on a flat surface with the camera mounted, it could possibly cause stress or damage to the camera.

Holding the ST-1000

Operating the ST-1000 with two hands provides the best control of your camera. Using one hand is less precise than using two, but it can be very useful for shots high over your head, shooting off to one side, or moving through a crowd.

For a two-handed grip, (see Fig. 1) take the grip in one hand and support the weight of the camera. This hand carries the ST-1000 with your camera attached, avoiding contact with anything that could disrupt the smooth flow of your shot. The supporting hand doesn't pan or tilt the camera or do anything other than support it as firmly as possible. With the thumb and two fingertips of your other hand, touch the control ring lightly when you want to change where the camera is pointing.

Move the knurled ring to pan, and press the bottom of the receiver mount to tilt the camera. If possible, don't let this operating hand touch

the supporting hand, unless you need two hands to support the weight of your camera. You can slide the little finger of the operating hand between the fingers of supporting hand to help support the weight in that case, while keeping a light touch on the control ring.

If you're using one hand to support the ST-1000, (see Fig. 2) place your hand on the grip, so that your second finger is just below the control ring. Use your second, third, and pinky finger to firmly hold the grip. Wrap your index finger around the base of the receiver mount and your thumb on the control ring. You can use your arm as a crank when you pan, while you use your thumb to pan or tilt the camera, using the control ring.

Visit RevoCinema.com for more information on our complete line of video mounting products.

Fig. 1

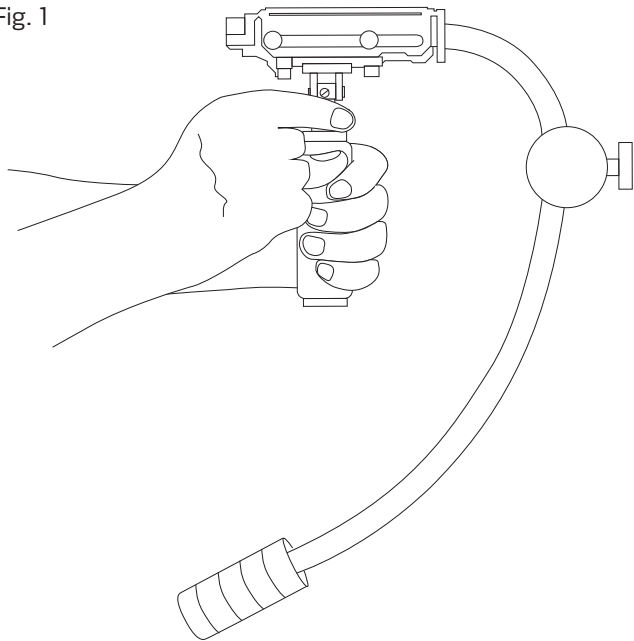
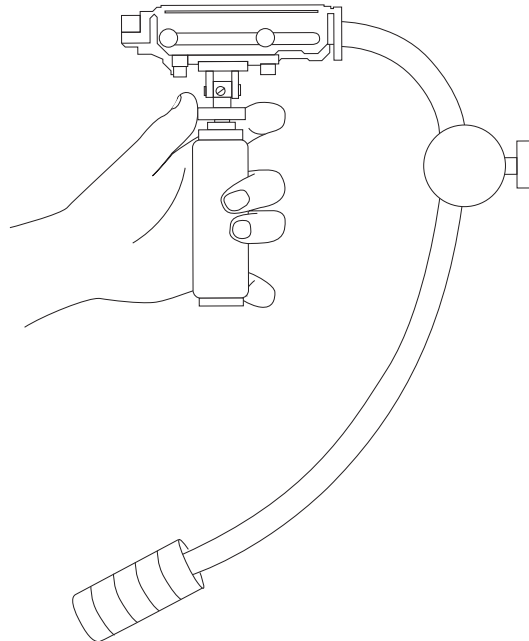

Fig. 2



Notes

This image shows a single sheet of white paper with horizontal blue or grey ruling lines. The lines are evenly spaced and run across the width of the page. There are approximately 20 lines visible. The paper has a slight shadow on its right side, suggesting it's resting on a surface.This image shows a full page of white paper with horizontal blue or grey ruling lines. The lines are evenly spaced and run across the width of the page, providing a template for handwriting practice. There are no margins, text, or other markings on the page.

