

Table of Contents:

Instructions.....	2-3
Available Accessories.....	4
Warning	5
Warranty.....	6



SMH-1200

PROFESSIONAL STUDIO MONITOR HEADPHONES

Thank you for choosing Senal.

The SMH series headphones feature Senal's twist-locking jack allowing compatible cables and accessories to be attached.

Senal offers a wide range of accessories to expand the functionality of your headphones and enhance your listening experience.

To attach cable: Fully insert plug. A quarter turn **CLOCKWISE** locks the plug into place.

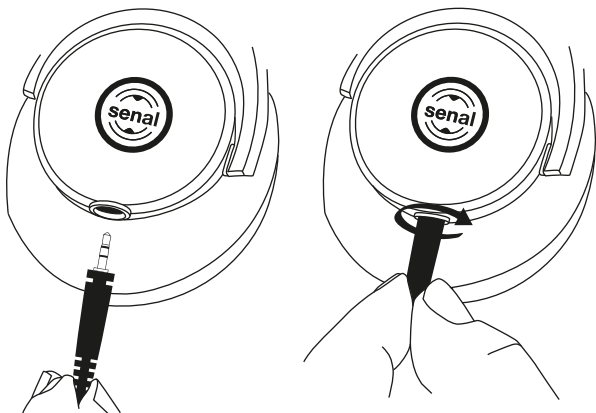

To detach cable: Turn the plug **COUNTERCLOCKWISE** a quarter turn and remove it from the jack.

Connecting the Mobile Device Cable

1. Fully insert the Mobile Device Cable's 2.5 mm connector into your SMH headphone's 2.5 mm receptacle, and rotate the connector clockwise to lock it in place.
2. Fully insert the cable's 3.5 mm connector into your device's headphone jack.

Controlling Audio Playback

To play or pause your music, press the button once.

To skip forward one track, press the button twice.

To skip backward one track, press the button three times.

Using the Call Functions

To answer or end a call, press the button once.

To ignore an incoming call, press and hold the button for about two seconds.

To switch between the current call and an incoming or on-hold call, press the button once.

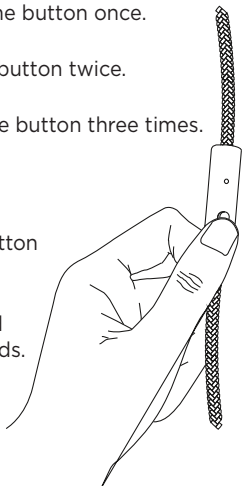

Note: The SMH-MT4 is compatible with iOS® devices. For full functionality on select Android devices, a third party app for assigning headset controls such as Headset Button Controller may be required.

iOS® is a registered trademark of Cisco.

Available Accessories

SMH-PADED - Extra deep ear cushions

SMH-PAD - Standard ear cushions

SMH-PADL - Genuine sheepskin leather ear cushions

SMH-PADV - Deluxe velour-coated ear cushions

SMH-PC10 - Replacement 10' coiled cable

Detachable twist-locking cable with threaded 1/8" stereo mini connector.

SMH-MT4 - Replacement 4' fabric cable with mobile control

Durable detachable cable with integrated microphone and control button for smartphone or portable media device.

SMH-POUCH - Carry/storage pouch

Soft draw-string carrying pouch for SMH series headphones.

SMH-PS03 - 3' straight detachable cable

Detachable twist-locking cable provides a quick and easy connection to a camera or portable device.

SMH-BCM - Broadcast headset attachment

Broadcast and communication boom microphone attachment.

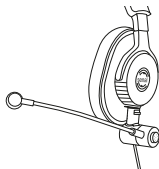

SMH-1200 Studio Monitor Headphones are available in a variety of colors:

- **SMH-1200-BL** - Nautical Blue
- **SMH-1200-BU** - Burgundy
- **SMH-1200-LER** - Cherry Red
- **SMH-1200-OX** - Onyx

Warning

Protect your hearing!

Exposure to high sound pressure levels may cause permanent hearing loss. Avoid listening at high volumes for extended periods.

Symptoms of noise-induced hearing loss may include persistent ringing, pain, itching, or inflammation of the ears, and difficulty understanding speech.

For more information visit:

<http://www.osha.gov/SLTC/noisehearingconservation/>

<http://www.cdc.gov/niosh/topics/noise/>

Please note: Government URLs are subject to change. If these links don't connect you to the right information, we recommend that you visit www.cdc.gov and www.osha.gov or do an Internet search for the phrase "hearing loss."

Three-Year Limited Warranty

This SENAL product is warranted to the original purchaser to be free from defects in materials and workmanship under normal consumer use for a period of three (3) years from the original purchase date or thirty (30) days after replacement, whichever occurs later. The warranty provider's responsibility with respect to this limited warranty shall be limited solely to repair or replacement, at the provider's discretion, of any product that fails during normal use of this product in its intended manner and in its intended environment. Inoperability of the product or part(s) shall be determined by the warranty provider. If the product has been discontinued, the warranty provider reserves the right to replace it with a model of equivalent quality and function.

This warranty does not cover damage or defect caused by misuse, neglect, accident, alteration, abuse, improper installation or maintenance. EXCEPT AS PROVIDED HEREIN, THE WARRANTY PROVIDER MAKES NEITHER ANY EXPRESS WARRANTIES NOR ANY IMPLIED WARRANTIES, INCLUDING BUT NOT LIMITED TO ANY IMPLIED WARRANTY OF MERCHANTABILITY OR FITNESS FOR A PARTICULAR PURPOSE. This warranty provides you with specific legal rights, and you may also have additional rights that vary from state to state.

To obtain warranty coverage, contact the Senal Customer Service Department to obtain a return merchandise authorization ("RMA") number, and return the defective product to Senal along with the RMA number and proof of purchase. Shipment of the defective product is at the purchaser's own risk and expense.

For more information or to arrange service, visit www.senalsound.com or call Customer Service at 212-594-2353.

Product warranty provided by the Gradus Group.
www.gradusgroup.com

Senal is a registered trademark of the Gradus Group.
© 2014 Gradus Group LLC. All Rights Reserved.

