

WARRANTY REGISTRATION

Visit www.ultimatesupport.com for a quick and convenient process for registering your new Ultimate Support product. Warranty Registration and Proof of Purchase are required for warranty fulfillment. Full Limited Lifetime Warranty and Ultimate Protection Plus Premium Service and Support Plan details are available online under Music Gear & Instrument Stands / Customer Support.

ULTIMATE
SUPPORT™

LIMITED LIFETIME WARRANTY

Ultimate Support products are constructed of the finest materials and designed and tested to stand up to the demanding lifestyle of the touring musician, gigging DJ, and working sound engineer. In the unlikely event that a product should fail due to manufacturing defect, Ultimate Support is pleased to repair or replace that product.

Please see www.ultimatesupport.com for more information.

This warranty applies to the original purchaser only and does not include damage to the product resulting from normal wear and tear, accident, misuse, improper installation or operation, or unauthorized repair or alterations.

ULTIMATE
SUPPORT™

THE STRENGTH OF INNOVATION

Product Manual for Ultimate Support IQ SERIES® KEYBOARD STAND

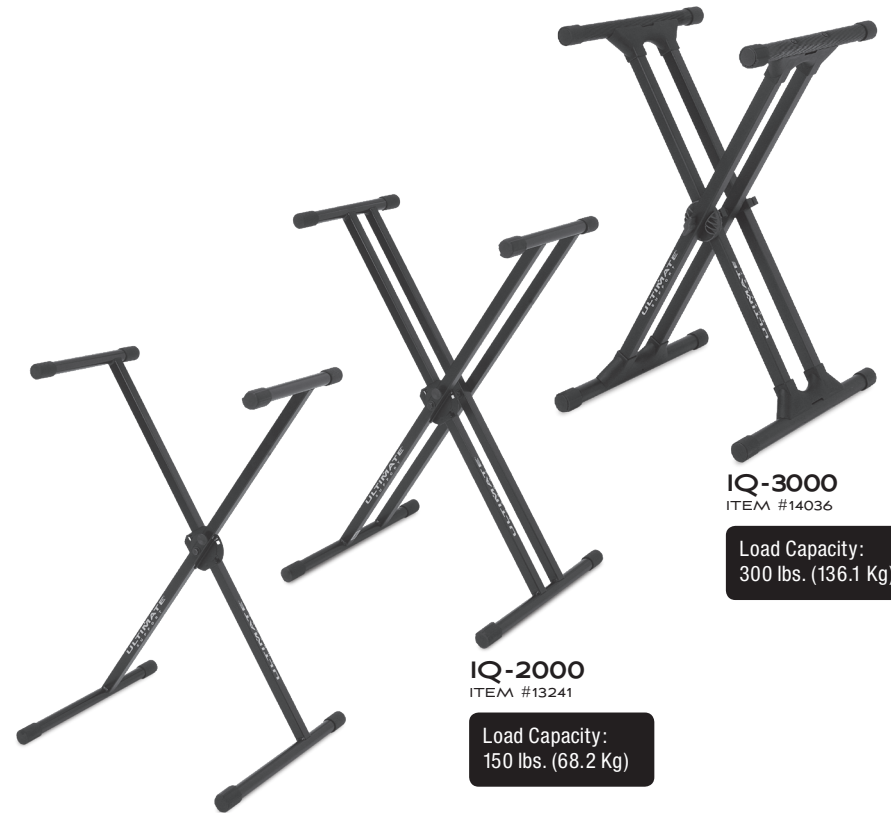

IQ-3000
ITEM #14036

Load Capacity:
300 lbs. (136.1 Kg)

IQ-2000
ITEM #13241

Load Capacity:
150 lbs. (68.2 Kg)

IQ-1000
ITEM #13231

Load Capacity:
100 lbs. (45.5 Kg)

ULTIMATE
SUPPORT™

LIMITED LIFETIME WARRANTY

IQ-3000 SETUP INSTRUCTIONS



1. Stand the IQ-3000 upright with longer tubes on the floor and Memory Lock facing you. Open the IQ-3000 up about 12".



2. Loosen Memory Lock knob by turning it counter-clockwise about five (5) complete turns (being sure not to over loosen).



3. Holding Memory Lock front plate in left hand and back plate in right hand, rotate plates in opposite directions and align "hash marks" to set desired height setting. There are nine (9) height options.



4. Tighten Memory Lock knob clockwise.



5. Open IQ-3000 fully.

NOTE: Your IQ-3000 will open to this height every time you use it unless a new height is desired. Repeat steps 1-5 to change height setting.

IQ-1000 / IQ-2000 SETUP INSTRUCTIONS

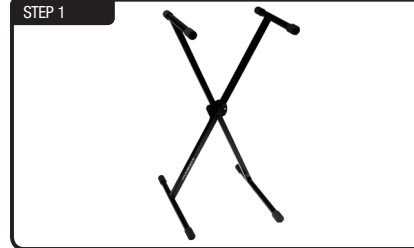

1. Set the IQ-1000 or IQ-2000 upright so that the longer leg tubes are on the floor. Fully open the stand to the pre-set position (there should be a noticeable resistance as the plate catches the leg detent).



2. With the Memory Lock facing you, hold top left tube with left hand and with your right hand pull the Memory Lock knob toward you, being sure to fully retract the pin from the Memory Lock plate.



3. Holding the extracted Memory Lock pin with right hand, pivot the "X" brace with left hand to desired height and release pin. Be sure the Memory Lock is fully and securely engaged before placing keyboard on stand.

NOTE: Your IQ-1000 or IQ-2000 will open to this height every time you use it unless a new height is desired. Repeat steps 1-3 to change height setting.

ADJUSTING END CAPS

IQ-3000 / IQ-2000 / IQ-1000

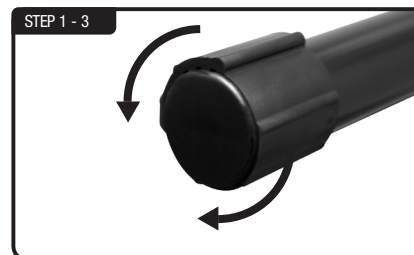

1. Open stand to fully open position.
2. If stand rocks on an uneven surface, turn black end cap on bottom tube to a different thickness to correct.
3. End cap on top tube can also be adjusted to secure keyboard.