



BG-C7

BATTERY GRIP

Designed For The Canon
Rebel T3 SLR Camera



Introduction

Thank you for choosing Vello and congratulations on your new BG-C7 battery grip purchase. Enjoy the many benefits that a battery grip offers, such as extended shooting time and more control and comfort when shooting in a vertical (portrait) orientation.

The Vello BG-C7 is compatible with the Canon T3 DSLR camera. The BG-C7 accepts up to two Canon LP-E10 rechargeable batteries. The BG-C7 is equipped with an alternate shutter-release button that triggers the camera via the included shutter release cable for shooting in a vertical position.

Please read through this entire manual before using the BG-C7 battery grip.



Precautions

- 1.** The BG-C7 should only be used with compatible devices specified in this manual.
- 2.** Only use with batteries recommended in this manual.
- 3.** Cover the power terminals with the contact cap when the BG-C7 is not in use. This prevents electrical shorts caused by metal objects touching the power terminals.
- 4.** If you notice smoke, an unusual smell or noise from the battery pack, discontinue use immediately. Remove the batteries and take the device to a Vello authorized reseller.
- 5.** The BG-C7 does not have a power switch. Instead, use the camera power switch to turn the power on or off.
- 6.** The battery level may not display properly if batteries are inserted before mounting the grip.
- 7.** Remove batteries from the grip when not in use.
- 8.** Do not attempt to disassemble.
- 9.** Avoid water or extreme humidity and keep in a dry and cool place.
- 10.** Keep out of reach of children.

Overview

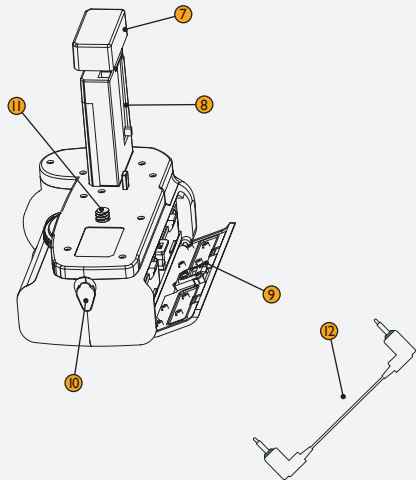
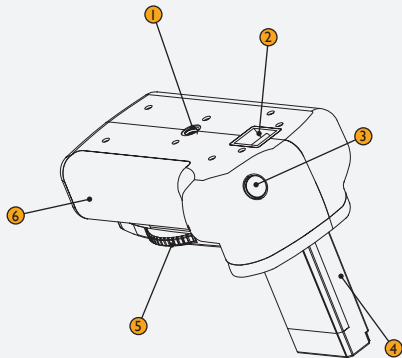

① Tripod Socket

Allows the camera to be mounted to a tripod when the grip is mounted.

② Hand Strap Mount

Provides bottom mounting position for the use of a hand strap.

③ Shutter Release Button

Use as an alternate shutter release button for shooting in vertical (portrait) mode.

④ Camera Battery Door Holder

Stores the camera's battery chamber door when the grip is mounted.

⑤ Attachment Wheel

Secures the grip to the camera's tripod socket.

⑥ Anti-Slip Rubber Grip

Provides secure and comfortable grip when shooting vertically.

⑦ Contact Cap

Protects metal power contacts. Keep this cap on when the grip is not connected to the camera.

⑧ Power Contacts

Slides into the camera's battery chamber and transmits power.

⑨ Battery Chamber Cover

Secures up to two Canon LP-E10 batteries.

⑩ Cable Connecting Socket

Accepts sub mini connector of the shutter release cable.

⑪ Mounting Screw

Connects to the camera's tripod socket.

⑫ Shutter Release Cable

Transmits shutter release signal from battery grip to the camera.

Power Source	Two Canon LP-E10 Rechargeable Batteries
Operating Temperature	32 – 104 °F (0 – 40 °C)
Dimensions	Approximately 148x40x30mm
Weight	Approximately 5.1 oz. (144 g) excluding batteries

Attaching The Grip



1. Ensure that the power is turned off on the camera.

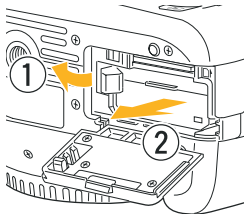

2. Turn the camera upside down and open the camera battery chamber. Pull gently at a 35° angle until the chamber door comes loose.

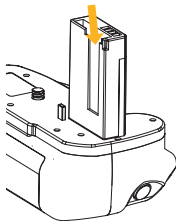

3. Slide the camera battery chamber door into the BG-C7 chamber door holder in order to avoid loss.

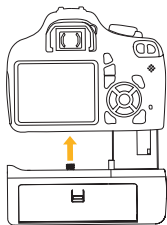

4. Insert the grip power contacts into the camera's battery chamber as shown. Make sure to align the camera's tripod socket with the mounting screw.

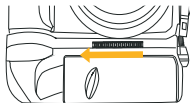

5. Rotate the attachment wheel in the direction shown by the arrow until it is firmly tightened.

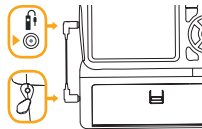

6. Connect Shutter Release Cable from the socket on the end of the battery grip to the remote release port on the Canon T3 body.



Look for this symbol to locate the jack for connecting remote devices.

7. Insert the batteries (may be used with only one battery), turn the camera on, and check the battery level on the LCD or viewfinder.

When removing the grip, turn the camera power off, remove batteries, and replace protective contact cap.

Warranty

Vello provides a limited warranty that this product is free from defects in materials and workmanship to the original purchaser under normal use for a period of one (1) year from the original purchase date or thirty (30) days after replacement whichever occurs later. Vello's responsibility with respect to this limited warranty shall be limited solely to repair or replacement, at its option, of any product which fails during normal consumer use. This warranty does not extend to damage or failure which results from misuse, neglect, accident, alteration, abuse, improper installation or maintenance. To obtain a replacement during the time of this warranty, please return the defective item with proof of purchase along with an RMA number to the place of purchase. This warranty gives you specific legal rights, and you may also have other rights which vary from state to state.



www.vellogear.com

© Copyright 2012 Gradus Group

All other trademarks are the property of their respective owners