



BG-N12

BATTERY GRIP

Designed for the Nikon
D3100/D3200/D3300 SLR Cameras

 VELLO™

USER'S MANUAL

Introduction

Thank you for choosing Vello and congratulations on your new BG-N12 battery grip purchase. Enjoy the many benefits that a battery grip offers, such as extended shooting time and more control and comfort when shooting in a vertical (portrait) orientation.

The Vello BG-N12 is compatible with the Nikon D3100/D3200/D3300 DSLR cameras. The BG-N12 accepts up to two Nikon EN-EL14 or EN-EL14a rechargeable batteries (not included). The BG-N12 is equipped with an alternate shutter-release button that triggers the camera via the included shutter release cable for shooting in a vertical position.



Please read through this entire manual before using the BG-N12 battery grip.

Precautions

- 1.** The BG-N12 should only be used with compatible devices specified in this manual.
- 2.** Only use with batteries recommended in this manual. The BG-N12 can not be used with other battery holders.
- 3.** Cover the power terminals with the contact cap when the BG-N12 is not in use. This prevents electrical shorts caused by metal objects touching the power terminals.
- 4.** If you notice smoke, an unusual smell or noise from the battery pack, discontinue use immediately. Remove the batteries and take the device to a Vello authorized reseller.
- 5.** The BG-N12 does not have a power switch. Instead, use the camera power switch to turn the power on or off.
- 6.** The battery level may not display properly if batteries are inserted before mounting the grip.
- 7.** Remove batteries from the grip when not in use.
- 8.** Do not attempt to disassemble.
- 9.** Avoid water or extreme humidity and keep in a dry and cool place.
- 10.** Keep out of reach of children.

Overview

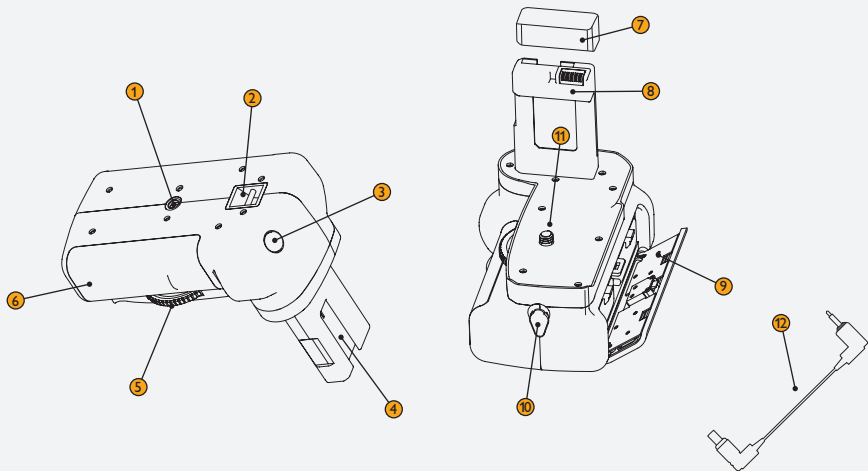

① Tripod Socket

Allows the camera to be mounted to a tripod when the grip is mounted.

② Hand Strap Mount

Provides bottom mounting position for the use of a hand strap.

③ Shutter Release Button

Use as an alternate shutter release button for shooting in vertical (portrait) mode.

④ Camera Battery Door Holder

Stores the camera's battery chamber door when the grip is mounted.

⑤ Attachment Wheel

Secures the grip to the camera's tripod socket.

⑥ Anti-Slip Rubber Grip

Provides secure and comfortable grip when shooting vertically.

⑦ Contact Cap

Protects metal power contacts. Keep this cap on when the grip is not connected to the camera.

⑧ Power Contacts

Slides into the camera's battery chamber and transmits power.

⑨ Battery Chamber Cover

Secures up to two Nikon EN-EL14 or EN-EL14a batteries.

⑩ Cable Connecting Socket

Accepts sub mini connector of the shutter release cable.

⑪ Mounting Screw

Connects to the camera's tripod socket.

⑫ Shutter Release Cable

Transmits shutter release signal from battery grip to the camera.

Power Source	Two Nikon EN-EL14 or EN-EL14a Rechargeable Batteries
Operating Temperature	32 – 104 °F (0 – 40 °C)
Dimensions	5" × 3.1" × 4" (12.6 × 8 × 10 cm)
Weight	4.8 oz. (138 g) excluding batteries

Attaching The Grip



1. Ensure that the power is turned off on the camera.

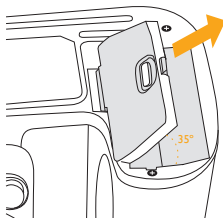

2. Turn the camera upside down and open the camera battery chamber. Pull gently at a 35° angle until the chamber door comes loose.

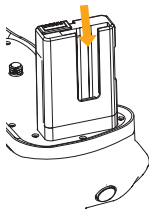

3. Slide the camera battery chamber door into the BG-N12 chamber door holder in order to avoid loss.

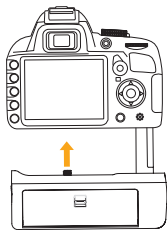

4. Insert the BG-N12 grip power contacts into the camera's battery chamber as shown. Make sure to align the camera's tripod socket with the BG-N12 mounting screw.

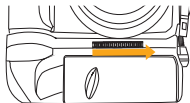

5. Rotate the attachment wheel in the direction shown by the arrow until it is firmly tightened.

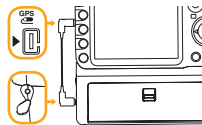

6. Connect the shutter release cable from the socket on the end of the battery grip to the remote release/GPS port on the D3100/D3200/D3300 body.
7. Turn the camera on and check the battery level on the LCD or viewfinder.

When removing the grip, turn the camera power off, remove batteries, and replace the protective contact cap.

ONE-YEAR LIMITED WARRANTY

This VELLO product is warranted to the original purchaser to be free from defects in materials and workmanship under normal consumer use for a period of one (1) year from the original purchase date or thirty (30) days after replacement, whichever occurs later. The warranty provider's responsibility with respect to this limited warranty shall be limited solely to repair or replacement, at the provider's discretion, of any product that fails during normal use of this product in its intended manner and in its intended environment. Inoperability of the product or part(s) shall be determined by the warranty provider. If the product has been discontinued, the warranty provider reserves the right to replace it with a model of equivalent quality and function.

This warranty does not cover damage or defect caused by misuse, neglect, accident, alteration, abuse, improper installation or maintenance. EXCEPT AS PROVIDED HEREIN, THE WARRANTY PROVIDER MAKES NEITHER ANY EXPRESS WARRANTIES NOR ANY IMPLIED WARRANTIES, INCLUDING BUT NOT LIMITED TO ANY IMPLIED WARRANTY OF MERCHANTABILITY OR FITNESS FOR A PARTICULAR PURPOSE. This warranty provides you with specific legal rights, and you may also have additional rights that vary from state to state.

To obtain warranty coverage, contact the Vello Customer Service Department to obtain a return merchandise authorization ("RMA") number, and return the defective product to Vello along with the RMA number and proof of purchase. Shipment of the defective product is at the purchaser's own risk and expense.

For more information or to arrange service, visit www.vellogear.com or call Customer Service at 212-594-2353.

Product warranty provided by the Gradus Group.

www.gradusgroup.com

VELLO is a registered trademark of the Gradus Group. © 2014 Gradus Group LLC. All Rights Reserved.



www.vellogear.com

© Copyright 2014 Gradus Group LLC
All other trademarks are the property of their respective owners
GG2