



# BG-N2

## BATTERY GRIP

Designed For The Nikon D80  
And D90 Cameras

 VELLO™

USER'S MANUAL

# Introduction

Thank you for choosing Vello and congratulations on your new BG-N2 battery grip purchase. Enjoy the many benefits that a battery grip offers, such as extended shooting time and more control and comfort when shooting in a vertical (portrait) orientation.

The Vello BG-N2 is compatible with the Nikon D80 and D90 DSLR cameras. Up to (2) Nikon EN-EL3e rechargeable batteries may be used to increase your shooting time, or six AA batteries (alkaline, Ni-MH, lithium, or nickel-manganese) for added convenience. The BG-N2 is equipped with an alternate shutter-release button, an AE-L/AF-L button, and main and sub-command dials for shooting in a vertical orientation.

*Please read through this entire manual before using the BG-N2 battery grip.*



# Precautions

- 1.** The BG-N2 should only be used with compatible devices specified in this manual.
- 2.** Only use with batteries and battery holders recommended in this manual. The BG-N2 can not be used with Nikon EN-EL3a/EN-EL3 Li-ion batteries or other battery holders.
- 3.** Cover the power terminals with the contact cap when the BG-N2 is not in use. This prevents electrical shorts caused by metal objects touching the power terminals.
- 4.** When the AA battery holder is removed from the BG-N2, remove the batteries or place the holder in a container to prevent electrical shorts caused by contact with other metal objects.
- 5.** If you notice smoke, an unusual smell or noise from the battery pack, discontinue use immediately. Remove the batteries and take the device to a Vello authorized reseller.
- 6.** The BG-N2 does not have a power switch. Instead, use the camera power switch to turn the power on or off.
- 7.** The battery level may not display properly if batteries are inserted before mounting the grip.
- 8.** Remove batteries from the grip when not in use.
- 9.** Do not attempt to disassemble.
- 10.** Avoid water or extreme humidity and keep in a dry and cool place.
- 11.** Keep out of reach of children.

# Overview

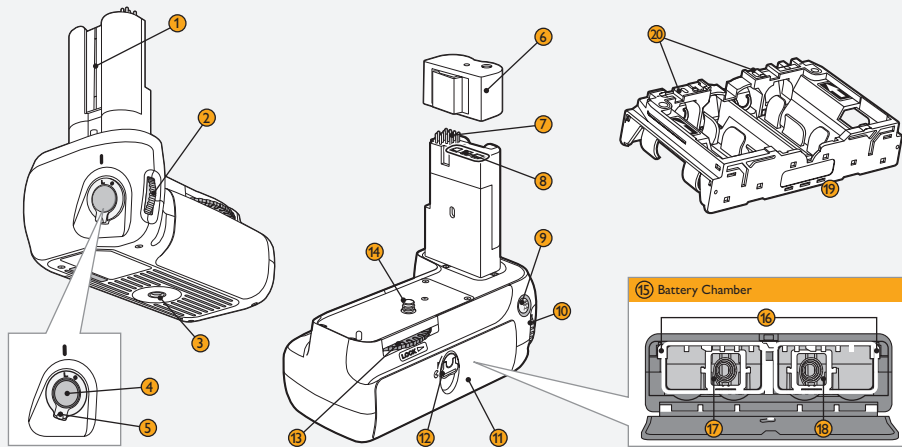

### ① Battery Chamber Cover Holder

### ② Sub-Command Dial \*

The sub-command dial performs the same function as on the camera.

### ③ Tripod Socket

### ④ Shutter-Release Button

The BG-N2 provides an alternate shutter-release button which performs the same functions as the shutter-release on the camera.

### ⑤ Control Lock Switch

To prevent accidental triggering, the control lock switch locks the shutter-release button, AE-L/AF-L button, as well as the main and sub-command dials on the BG-N2. Unlock prior to use by switching to the ● position. The

control lock is not a power switch.

### ⑥ Contact Cap

### ⑦ Signal Contacts

### ⑧ Power Terminals

### ⑨ AE-L/AF-L Button

The BG-N2 provides an alternate AE-L/AF-L button. On the Nikon D90, the AE-L/AF-L button can be customized using Custom Setting a6.

### ⑩ Main Command Dial \*

The main command dial performs the same function as on the camera.

### ⑪ Battery Chamber Cover

### ⑫ Battery Chamber Latch

### ⑬ Attachment Wheel

### ⑭ Mounting Screw

### ⑮ Battery Chamber

### ⑯ Battery Latches

### ⑰ Left Battery Slot

### ⑱ Right Battery Slot

### ⑲ AA Battery Holder

### ⑳ Battery Holder Power Terminals

\* Changes to Custom Setting 15 on the D80 or to Custom Setting f5 on the D90 also affect the main and sub-command dials on the BG-N2 (See camera manual for details).

# Attaching The Grip



1. Ensure that the power is turned off on the camera and that the Control Lock on the BG-N2 is in the **L** position before attaching the grip.

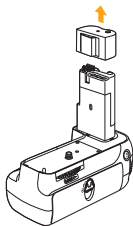

2. Remove the contact cap from the BG-N2 grip. This cap can slide onto the camera strap when removed from the grip. Replace the cap when not in use to protect the metal contacts.

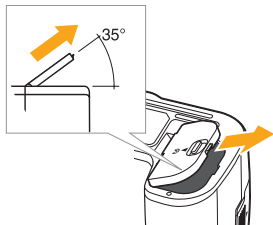

3. Open and remove the battery-chamber cover from the bottom of the camera handgrip and remove battery, if present.

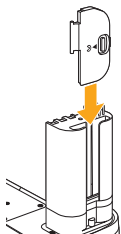

- 4.** To prevent loss, slide the cover into the cover holder on the BG-N2.

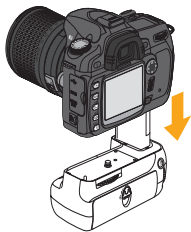

- 5.** Insert the BG-N2 grip into the camera's battery chamber (as shown).

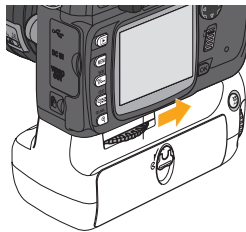

- 6.** Rotate the attachment wheel in the direction shown by the LOCK arrow until it is firmly tightened.

*The BG-N2 grip can also be inserted in the camera after the battery or battery holder is inserted.*

# Inserting Batteries



1. Ensure that the power is turned off on the camera and that the Control Lock on the BG-N2 is in the **L** position.

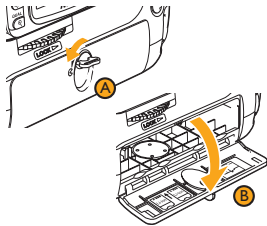

2. Turn the battery-chamber latch counter-clockwise to open the BG-N2 battery chamber door.

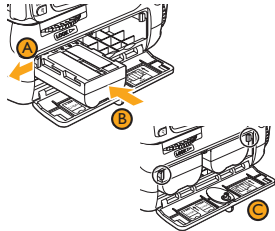

3. Nikon EN-EL3e Batteries: Insert one or two batteries into either of the battery chambers. The battery latch will slide aside during insertion and pop up to lock the battery in place when fully inserted.



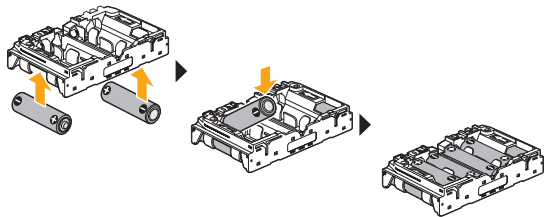

- 4. AA Batteries:** Place six AA batteries in the AA battery holder as shown and slide the holder into the battery chamber. Two battery latches lock the battery holder in place when fully inserted. *Note: When using AA batteries, all six batteries must be of the same type.*

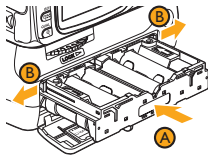



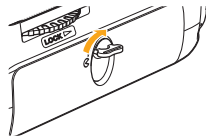





- 5.** Close the battery chamber and then turn the latch clockwise to lock it. Turn the camera on and check the battery level in the control panel or viewfinder.







# Battery Info

The camera displays the following battery levels .

Nikon EN-EL3e Batteries:

Control Panel	Viewfinder	Description
	—	Battery fully charged.
	—	Battery partially discharged.
		
		
		Low battery. Prepare spare batteries.
 (blinking)	 (blinking)	Battery exhausted. Shutter release is disabled.

AA Batteries:

Control Panel	Viewfinder	Description
	—	Battery fully charged.
		Low battery. Prepare spare batteries.
 (blinking)	 (blinking)	Battery exhausted. Shutter release is disabled.

## AA Battery Settings

To ensure that the camera shows the correct battery level when AA batteries are used, choose the appropriate setting for Custom Setting 32 in the Custom Settings menu for the D80, or for Custom Setting d12 in the Custom Settings menu for the D90.

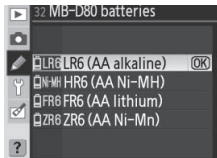

Battery Type	Menu Option To Select
AA alkaline (LR6)	LR6 (AA alkaline)
AA Ni-MH (HR6)	HR6 (AA Ni-MH)
AA Lithium (FR6)	FR6 (AA lithium)
AA nickel-manganese (ZR6)	ZR6 (AA Ni-Mn)

## EN-EL3e Battery Info

The camera can display information on the Nikon EN-EL3e batteries via the Battery info option in the Setup Menu. Battery information is listed separately for each battery slot. The Nikon D80 does not display battery information for AA batteries, while the D90 only displays the battery level. (See camera manual for details)

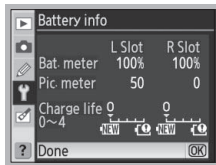

*Note: The menu screens on this page are from the D80.*

# Removing The Batteries

1. Being careful not to drop the battery or holder, remove them as shown below.

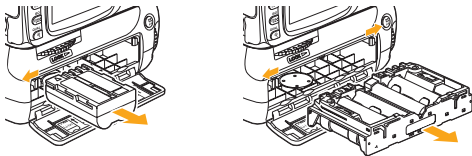

2. Remove the AA batteries using the holes on the back of the battery holder. Ensure that the batteries do not fall when removing them.

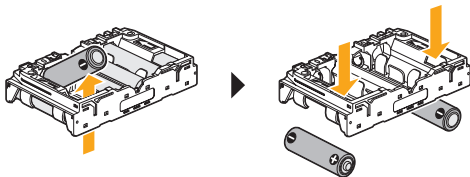

# Battery & Power

## EN-EL3e Batteries

At low temperatures of about 50° F (10° C) and below, the Nikon EN-EL3e batteries will decrease in performance. Warming up a cold battery can recover some of the lost charge. Use EN-EL3e batteries if possible. AA batteries have less capacity and lose more performance at low temperatures.

## AA Batteries

In most cases, Nikon EN-EL3e batteries will provide more performance than AA batteries when used in the Vello BG-N2. AA LR6 alkaline and ZR6 nickel-manganese batteries have limited capacity and therefore should only be used when there is no other alternative. Performance of AA batteries decreases significantly at temperatures below 20 °C (68 °F) and is not recommended. The AA battery holder is pre-inserted at the time of shipment.

## Using an AC Adapter

Remove the AA batteries before connecting an AC adapter, if the BG-N2 is inserted in the camera. Failure to observe this precaution may shorten the life of AA batteries.

*Remove the batteries when the BG-N2 is not in use.*

# Specifications

Power Source	One or two Nikon EN-EL3e rechargeable Li-ion batteries; six LR6 alkaline, HR6 Ni-MH, FR6 lithium, or ZR6 nickel-manganese AA batteries
Battery Life	Nikon D80: Approximately 5000 shots (two EN-EL3e batteries), 2500 shots (one EN-EL3e battery), or 480 shots (alkaline batteries). * Nikon D90: Approximately 8400 shots (two EN-EL3e batteries), 4200 shots (one EN-EL3e battery), or 1900 shots (alkaline batteries). *
Operating Temperature	32 – 104 °F (0 – 40 °C)
Dimensions	Approximately 5.4" × 2.9" × 4.3" (13.8 × 7.4 × 11 cm)
Weight	Approximately 7.4 oz. (230 g) (excluding batteries)

\* Approximate measurements.

Specifications and design are subject to change without notice.

# ONE-YEAR LIMITED WARRANTY

This VELLO product is warranted to the original purchaser to be free from defects in materials and workmanship under normal consumer use for a period of one (1) year from the original purchase date or thirty (30) days after replacement, whichever occurs later. The warranty provider's responsibility with respect to this limited warranty shall be limited solely to repair or replacement, at the provider's discretion, of any product that fails during normal use of this product in its intended manner and in its intended environment. Inoperability of the product or part(s) shall be determined by the warranty provider. If the product has been discontinued, the warranty provider reserves the right to replace it with a model of equivalent quality and function.

This warranty does not cover damage or defect caused by misuse, neglect, accident, alteration, abuse, improper installation or maintenance. EXCEPT AS PROVIDED HEREIN, THE WARRANTY PROVIDER MAKES NEITHER ANY EXPRESS WARRANTIES NOR ANY IMPLIED WARRANTIES, INCLUDING BUT NOT LIMITED TO ANY IMPLIED WARRANTY OF MERCHANTABILITY OR FITNESS FOR A PARTICULAR PURPOSE. This warranty provides you with specific legal rights, and you may also have additional rights that vary from state to state.

To obtain warranty coverage, contact the Vello Customer Service Department to obtain a return merchandise authorization ("RMA") number, and return the defective product to Vello along with the RMA number and proof of purchase. Shipment of the defective product is at the purchaser's own risk and expense.

For more information or to arrange service, visit [www.vellogear.com](http://www.vellogear.com) or call Customer Service at 212-594-2353.

Product warranty provided by the Gradus Group.

[www.gradusgroup.com](http://www.gradusgroup.com)

VELLO is a registered trademark of the Gradus Group. © 2015 Gradus Group LLC. All Rights Reserved.





© Copyright 2015 Gradus Group LLC  
All other trademarks are the property of their respective owners  
GG2