



# BG-S3

## BATTERY GRIP

Designed for the Sony Alpha  
A7II and A7R II Mirrorless Cameras



# Introduction

The Vello BG-S3 accepts two Sony NP-FW50 rechargeable batteries to effectively double the runtime of your Sony Alpha A7II and A7R II mirrorless cameras, making it easier to shoot for longer durations without replacing your camera's batteries.

The BG-S3 attaches securely to your camera's 1/4"-20 tripod socket, and the nonslip rubber on the grip offers enhanced handling when shooting in vertical position. Alternate shutter-release, AF/MF/AEL, and three custom buttons, plus front and rear command dials, make it comfortable to shoot in portrait orientation, so you won't have to twist your arm to get the right shot.

*Please read through this entire manual before using the BG-S3 battery grip.*



# Precautions

1. The BG-S3 should be used only with the compatible devices specified in this manual.
2. When the battery tray is removed from the grip, remove the batteries or place the tray in a container to prevent electrical shorts caused by contact with other metal objects.
3. If you notice smoke, an unusual smell or noise from the battery pack, discontinue use immediately. Remove the batteries and contact the Vello Customer Service Department.
4. Keep this product away from water and any flammable gases or liquids.
5. Set the grip's on/off switch to Off position to disable its controls when not shooting vertically.
6. The battery level may not display properly if batteries are inserted before mounting the grip.
7. Remove batteries from the grip when not in use.
8. Do not attempt to disassemble or repair this product.
9. Install batteries in the proper orientation. Installing batteries in the reverse orientation can cause them to leak, overheat, or explode.
10. Avoid water or extreme humidity and keep in a dry and cool place.
11. Keep out of reach of children.
12. Make sure that this product is intact and that there are no missing parts.
13. To avoid damage to this product, be careful not to overtighten or improperly thread any of the threaded fittings.
14. All photos are for illustrative purposes only.

# Overview

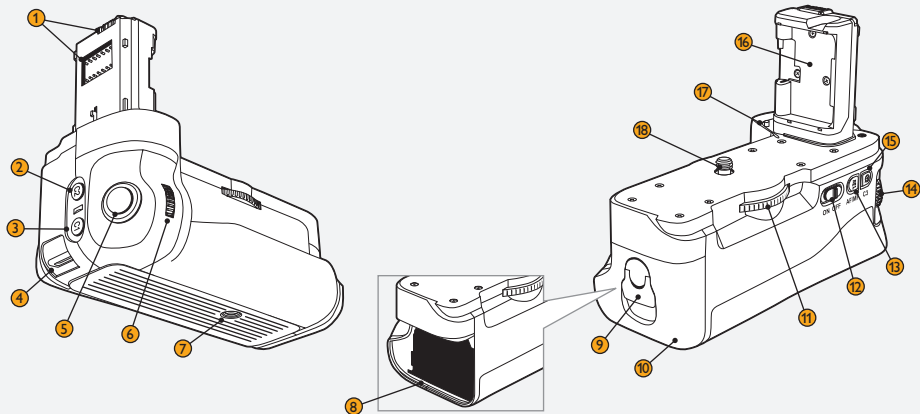

**① Electrical Contacts**

Communicates with the camera electronics.

**② Custom Button (C2)\***

**③ Custom Button (C1)\***

**④ Hand Strap Mount**

**⑤ Shutter-release Button\***

**⑥ Front Command Dial\***

**⑦ Tripod Socket**

**⑧ Battery Tray Compartment**

Houses the battery tray.

**⑨ Battery Tray Latch**

**⑩ Battery Tray**

Holds up to two Sony NP-FW50 batteries.

**⑪ Attachment Wheel**

Secures the grip to the camera.

**⑫ Grip On/Off Switch**

Activates or disables the BG-S3's controls. Your camera will continue to draw power from the BG-S3 when the switch is in the Off position. The on/off switch is not a power switch.

**⑬ AF/MF/AEL Button\***

**⑭ Rear Command Dial\***

**⑮ Custom Button (C3)\***

**⑯ Camera Battery Chamber Cover Compartment**

**⑰ Guide Pin**

Helps align the camera to the grip.

**⑱ Mounting Screw**

Attaches the grip through the camera's tripod socket.

*\*Performs the same function as on the camera.*

# Attaching the Grip

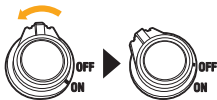

1. Ensure that the power is turned off on the camera and that the on/off switch is set to Off on the battery grip.

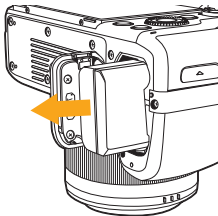

2. Remove the battery from your camera's battery chamber.

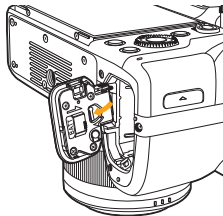

3. Remove your camera's battery chamber door by pulling the release latch on the inside of the door as indicated above.

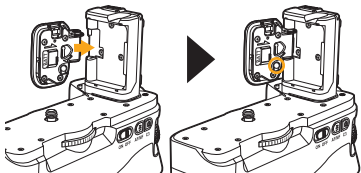

4. To prevent loss, place the battery chamber door into the BG-S3 battery door compartment. Align the door with the BG-S3's battery door compartment, and then insert the door. Press the door's release button to lock the door in place.



5. Swing the door shut and slide the switch to the LOCK position.

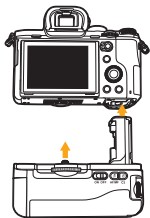

6. Connect the BG-S3 grip to the camera, while aligning the grip's mounting screw with the camera's tripod socket.



7. Rotate the attachment wheel in the direction shown by the arrow until it is firmly tightened.

*When removing the grip, turn the camera power off and remove the batteries.*



# Inserting Batteries

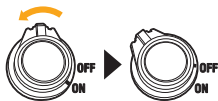

1. Ensure that the power is turned off on the camera and that the grip's on/off switch is set to Off.

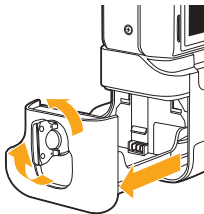

2. Flip the battery tray latch so you can rotate it counterclockwise and pull the battery tray out of the grip.

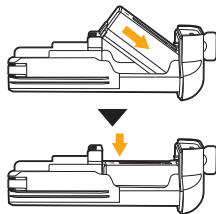

3. In the battery tray are compartments for batteries 1 and 2. Align battery 1 as indicated by the diagram, noting the springs inside the compartment. Insert battery 1 spring-side first, and push down so it snaps into place.

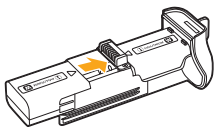

4. Align battery 2 as indicated by the diagram in the compartment, and slide it in until it snaps into place.

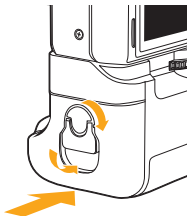

5. Make sure the battery tray latch is rotated counterclockwise and slide the battery tray into the grip. Rotate the latch clockwise and reposition it so it's flush with the side of the grip, then turn on the camera and grip.

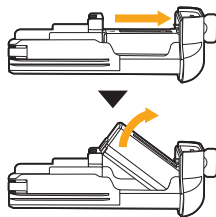

*To remove battery 1, pull the battery toward the springs and lift the battery up and out of the compartment.*

# Specifications

|                        |   |
|------------------------|---|
| Power Source           | One or two Sony NP-FW50 batteries         |
| Voltage Output         | 7.2–8.4 V                                 |
| Amps Output            | <3 A                                      |
| Operating Temperature  | 32°F–104°F (0°C–40°C)                     |
| Dimensions (W × D × H) | 5.03" × 2.5" × 3.95" (12.8 × 6.4 × 10 cm) |
| Weight                 | 7.5 oz. (212.6 g) without batteries       |

## Battery Status

When two batteries are installed in the BG-S3, your camera will automatically select the battery with lower power remaining. Both battery levels will appear on your camera's LCD, with battery level percentage displayed for only the battery in use. When that battery is depleted, your camera will switch to the other battery in the grip.

# ONE-YEAR LIMITED WARRANTY

This VELLO product is warranted to the original purchaser to be free from defects in materials and workmanship under normal consumer use for a period of one (1) year from the original purchase date or thirty (30) days after replacement, whichever occurs later. The warranty provider's responsibility with respect to this limited warranty shall be limited solely to repair or replacement, at the provider's discretion, of any product that fails during normal use of this product in its intended manner and in its intended environment. Inoperability of the product or part(s) shall be determined by the warranty provider. If the product has been discontinued, the warranty provider reserves the right to replace it with a model of equivalent quality and function.

This warranty does not cover damage or defect caused by misuse, neglect, accident, alteration, abuse, improper installation or maintenance. EXCEPT AS PROVIDED HEREIN, THE WARRANTY PROVIDER MAKES NEITHER ANY EXPRESS WARRANTIES NOR ANY IMPLIED WARRANTIES, INCLUDING BUT NOT LIMITED TO ANY IMPLIED WARRANTY OF MERCHANTABILITY OR FITNESS FOR A PARTICULAR PURPOSE. This warranty provides you with specific legal rights, and you may also have additional rights that vary from state to state.

To obtain warranty coverage, contact the Vello Customer Service Department to obtain a return merchandise authorization ("RMA") number, and return the defective product to Vello along with the RMA number and proof of purchase. Shipment of the defective product is at the purchaser's own risk and expense.

For more information or to arrange service, visit [www.vellogear.com](http://www.vellogear.com) or call Customer Service at 212-594-2353.

Product warranty provided by the Gradus Group.

[www.gradusgroup.com](http://www.gradusgroup.com)

VELLO is a registered trademark of the Gradus Group. © 2015 Gradus Group LLC. All Rights Reserved.



[www.vellogear.com](http://www.vellogear.com)

© Copyright 2015 Gradus Group LLC  
All other trademarks are the property of their respective owners.

GG2